



Galahad Close, Leicester Forest East

£249,950



HAMPSONS
ESTATE AGENTS

0116 214 7555

146 HINCKLEY ROAD, LEICESTER FOREST EAST, LE3 3JT

WWW.HAMPSONSESTATEAGENTS.CO.UK

TEANAHAMPSON@HAMPSONSESTATEAGENTS.CO.UK

Galahad Close, Leicester Forest East

Offered with no upward chain, this three bedroomed semi-detached home occupies a superb cul-de-sac location, is in good decorative order throughout and features a conservatory to the rear.









GROUND FLOOR

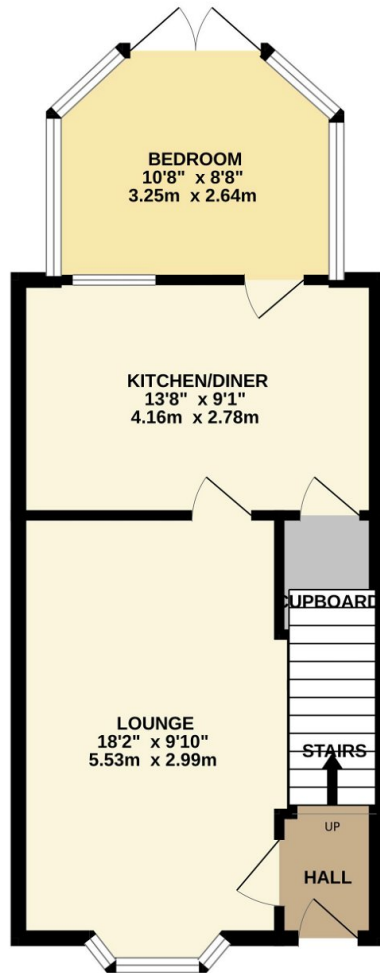

1ST FLOOR

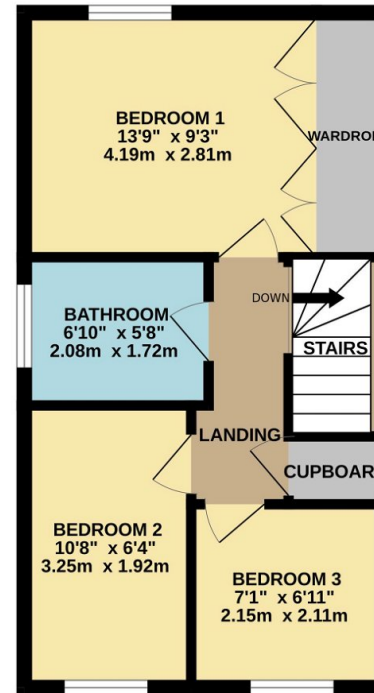

Whilst every attempt has been made to ensure the accuracy of the floorplan contained here, measurements of doors, windows, rooms and any other items are approximate and no responsibility is taken for any error, omission or mis-statement. This plan is for illustrative purposes only and should be used as such by any prospective purchaser. The services, systems and appliances shown have not been tested and no guarantee as to their operability or efficiency can be given.
Made with Metropix 6/2024

By law we carry out verification checks and proof of fund checks.

The details are intended to give a fair and reliable description of the property but no responsibility for any inaccuracy or error can be accepted. We have not tested any services or appliances and purchasers are advised to satisfy themselves as to the working order and condition.

Floor plans do not reflect exact dimensions or exactly replicate the layout of the property.

Referral Fees: EPC: up to £50. Mortgage: up to £500. Conveyancing up to £300. Survey: up to £50 all plus vat.

Registered in England and Wales number 12430282. Registered office: 3 Oswin Road, LE3 1NR.

