



Melton Street, Earl Shilton

£270,000



HAMPSONS  
ESTATE AGENTS

0116 214 7555

146 HINCKLEY ROAD, LEICESTER FOREST EAST, LE3 3JT

[WWW.HAMPSONSESTATEAGENTS.CO.UK](http://WWW.HAMPSONSESTATEAGENTS.CO.UK)

[TEANAHAMPSON@HAMPSONSESTATEAGENTS.CO.UK](mailto:TEANAHAMPSON@HAMPSONSESTATEAGENTS.CO.UK)

## Melton Street, Earl Shilton

A spacious three bedroomed detached bungalow offered with no upward chain featuring a contemporary kitchen and shower room and positioned in an ideal location in the heart of the town of Earl Shilton within walking distance of local amenities.









GROUND FLOOR  
762 sq.ft. (70.8 sq.m.) approx.

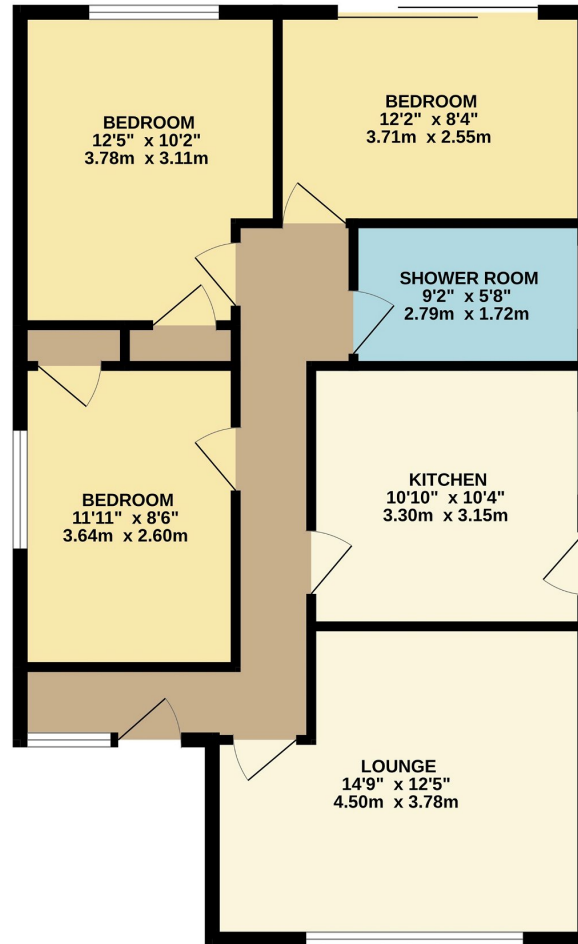

TOTAL FLOOR AREA : 762 sq.ft. (70.8 sq.m.) approx.

Whilst every attempt has been made to ensure the accuracy of the floorplan contained here, measurements of doors, windows, rooms and any other items are approximate and no responsibility is taken for any error, omission or mis-statement. This plan is for illustrative purposes only and should be used as such by any prospective purchaser. The services, systems and appliances shown have not been tested and no guarantee as to their operability or efficiency can be given.  
Made with Metropix ©2023

By law we carry out verification checks and proof of fund checks.

The details are intended to give a fair and reliable description of the property but no responsibility for any inaccuracy or error can be accepted. We have not tested any services or appliances and purchasers are advised to satisfy themselves as to the working order and condition.

Floor plans do not reflect exact dimensions or exactly replicate the layout of the property.

Referral Fees: EPC: up to £50. Mortgage: up to £500. Conveyancing up to £300. Survey: up to £50 all plus vat.

Registered in England and Wales number 12430282. Registered office: 3 Oswin Road, LE3 1NR.

