



POWERED BY
ROSIE MARLOW **exp** **UK**

@ rosie.marlow@exp.uk.com

rosiemarlow.exp.uk.com

01225 941 008

Eleanor Close

£295,000

3 1 1



Please quote Reference RM0334. This three bedroom end of terrace house is set in a lovely cul de sac. In need of some modernisation. Accommodation includes, sitting room, kitchen/ breakfast room, store, family bathroom and WC. The property has lovely front and rear gardens with a lovely open view. The gas combi boiler was fitted in 2014 and the house is double glazed.



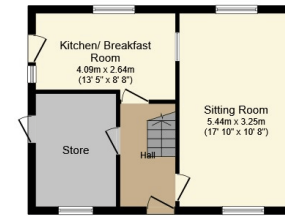

Ground Floor

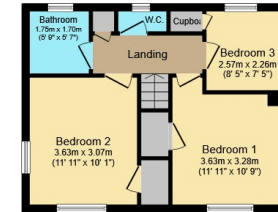

First Floor

Total floor area 80.9 sq.m. (871 sq.ft.) approx

This plan is for illustration purposes only and may not be representative of the property. Plan not to scale. Powered by PropertyBox

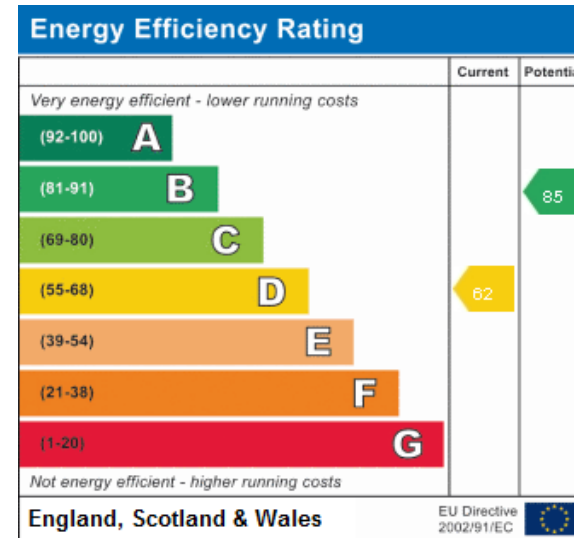

Address:
Eleanor Close

eXp World UK Ltd is a registered company at Level 37, 25 Canada Square, London, E14 5LQ.

Registered company number is 12016573. VAT Registration Number is 327 4120 29