



POWERED BY
ROSIE MARLOW **exp** **UK**

@ rosie.marlow@exp.uk.com

rosiemarlow.exp.uk.com

01225 941 008

Double Hill, Peasedown St. John

£339,950

3 1 1



Please quote reference RM0334. Beautifully presented three bedroom cottage with breath taking views. Accommodation includes open plan kitchen/ sitting room, lovely bathroom, the master bedroom has a Velux balcony window with stunning views over the valley. There is a lovely garden and patio area, allocated parking for two cars and a fantastic home office.



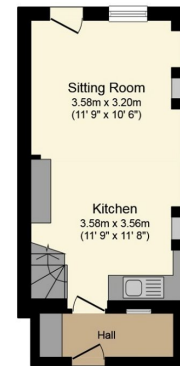

Ground Floor
Floor area 28.2 sq.m. (303 sq.ft.) approx

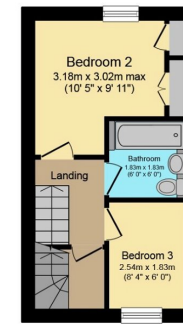

First Floor
Floor area 24.6 sq.m. (265 sq.ft.) approx

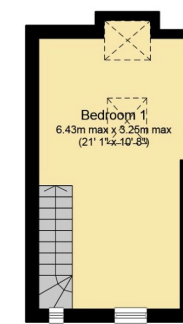

Second Floor
Floor area 23.5 sq.m. (253 sq.ft.) approx

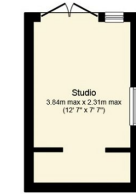

Outbuilding
Floor area 8.9 sq.m. (95 sq.ft.) approx



Total floor area 85.1 sq.m. (916 sq.ft.) approx

This Floor Plan is for illustration purposes only and may not be representative of the property. The position and size of doors, windows and other features are approximate. Unauthorised reproduction prohibited. © PropertyBox

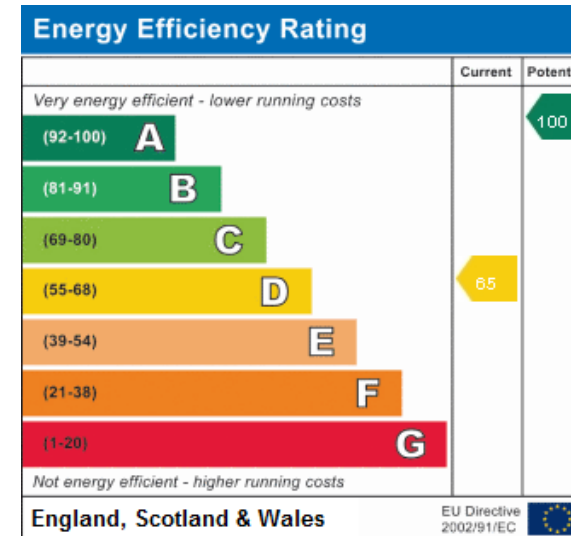

Address:
Double Hill