



POWERED BY
ROSIE MARLOW **exp** **UK**

@ rosie.marlow@exp.uk.com

rosiemarlow.exp.uk.com

☎ 01225 941 008

Englishcombe Lane, Bath, BA2 2EF

£275,000

🛏️ 2 🚿 2 🛋️ 1



A lovely two bedroom maisonette that feels more like a house with its own private entrance, communal gardens and allocated parking. At the end of a gated driveway, nestled within Englishcombe Park, you will find this unique period conversion. Once through the gates, you drive through landscaped gardens before parking in an allocated space and plenty of visitor parking. The communal gardens have areas of lawn, with seating areas under pergolas, along with a stream running alongside the drive. Tucked around the back of the building is where you will find the front door to this charismatic tranquil maisonette. As you enter the property you will find the bathroom and two double bedrooms on the ground floor with the master bedroom having an ensuite shower room. Upstairs you will find the open living space, with exposed ceiling beams. The upstairs kitchen/reception room is all open plan. This whole property offers lots of natural light with good sized windows and lovely high ceilings.



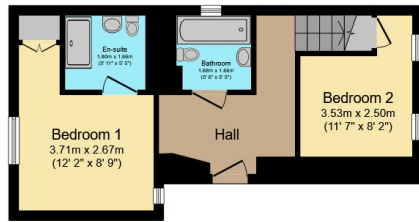

Ground Floor



First Floor

Total floor area 56.4 sq.m. (607 sq.ft.) approx
 This plan is for illustration purposes only and may not be representative of the property. Plan not to scale.

- Please Quote Reference RM0334
- Open Plan Sitting Room/ Kitchen
- One allocated off-street parking space
- Gas Central Heating
- An impressive upstairs living space with vaulted ceiling and exposed timber beams
- Two Double Bedroom Maisonette
- En suite Shower Room & Bathroom
- Picturesque communal gardens
- Private Entrance
- No Onward Chain

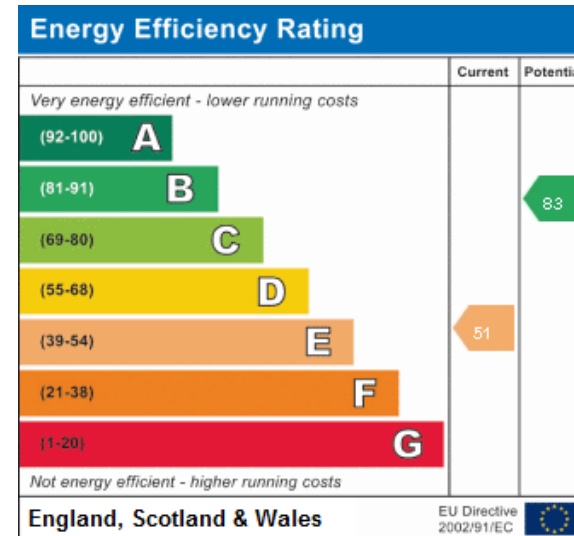

Address:
 Moorlands