



ROSIEMARLOW POWERED BY exp TM UK

@rosie.marlow@exp.uk.com

rosiemarlow.exp.uk.com

01225 941 008

## Riverside House, Osborne Road

£269,950

🛏️ 2 🚿 1 🚪 1



Please quote reference RM0334. Riverside House is a delightful building of four apartments. It has a residents car park with allocated parking a communal garden and communal bike store. The property is located on the ground floor with lovely river views. Accommodation includes sitting room, Kitchen, two double bedrooms and a bathroom.

The river area around Locksbrook is picturesque with the bridges and locks and has a cycle path to Bath and Bristol along the river. The area is fast becoming a go to location with the popular Locksbrook Inn pub with large terrace overlooking the river, a family run bakery offering fresh delicious products and the Electric Bear Brewery serving craft beer in an semi-industrial setting. On top of this Chelsea Road is a shopping centre that is less than 0.5 miles away and offers a plethora of shops and amenities.



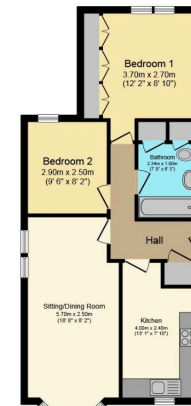

**Floor Plan**

Total floor area 59.9 sq.m. (645 sq.ft.) approx

This Floor Plan is for illustration purposes only and may not be representative of the property. The position and size of doors, windows and other features are approximate. Unauthorised reproduction prohibited. © PropertyBox

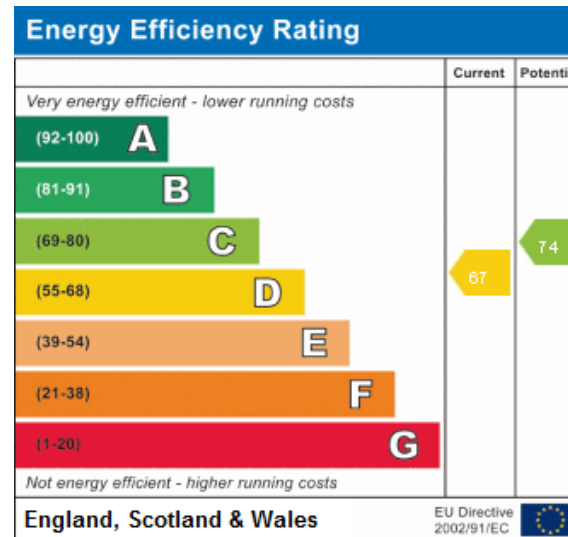

Address:  
Osborne Road