



ROSIE MARLOW POWERED BY exp TM UK

@ rosie.marlow@exp.uk.com

rosiemarlow.exp.uk.com

01225 941 008

Park Street
£289,950

🛏 2 🪑 1 🛋 2



Mole House is a lovely Period cottage situated in the heart of Hungerford just a short walk from the Town Centre, Hungerford Common and the Railway Station. This charming period cottage combines a lovely atmosphere with comfortable living accommodation over two floors. On the ground floor the Entrance Hall area gives access to a cosy sitting room with a central chimney breast housing a gas wood burner which links seamlessly to the Kitchen/ diner. The Kitchen is a lovely space with French doors onto the courtyard garden. A cloakroom/W.C completes the ground floor. Upstairs, there are two generous size Bedrooms, the master bedroom has triple aspect views and a family bathroom. Outside there is a courtyard garden and off street parking. This very special Cottage which is offered for sale with no onward chain.

ACCOMMODATION:

ENTRANCE HALL: Stairs to first floor with storage cupboard under, double glazed window to the rear.

CLOAKROOM: Low level WC, wash basin, window to the rear, plumbing for washing machine and space for tumble dryer.

SITTING ROOM: Three windows to the front, two radiators, gas wood burner with wooden surround and mantle, TV point.

KITCHEN/ DINING ROOM: Having a range of wooden fronted wall and floor units with wooden worktops, inset stainless steel single drainer one and a half bowl sink unit with mixer tap over, gas cooker point, cooker hood, tiled floor, fitted large cupboard, period fireplace, window to the front and side, French doors to the garden.

FIRST FLOOR

LANDING: Velux window, airing cupboard housing hot water tank.

BEDROOM ONE: windows to the front, side and rear, radiator, TV point, two fitted under eave cupboards.

BEDROOM TWO: Window to the front, radiator, phone point.

BATHROOM: Window to the front, clawfoot bath, high level WC



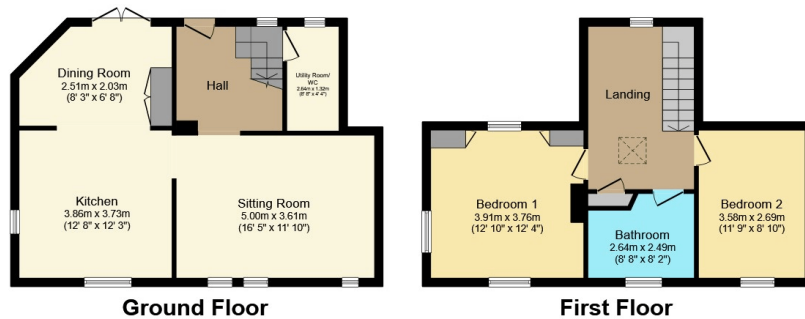

- Semi Detached Character Cottage
- Sitting Room
- Two Double Bedrooms
- Courtyard Garden
- No Onward Chain
- Kitchen/ Breakfast Room
- Cloakroom
- Bathroom
- Off Street Parking

Total floor area 95.9 sq.m. (1,032 sq.ft.) approx
This plan is for illustration purposes only and may not be representative of the property. Plan not to scale. Powered by PropertyBox

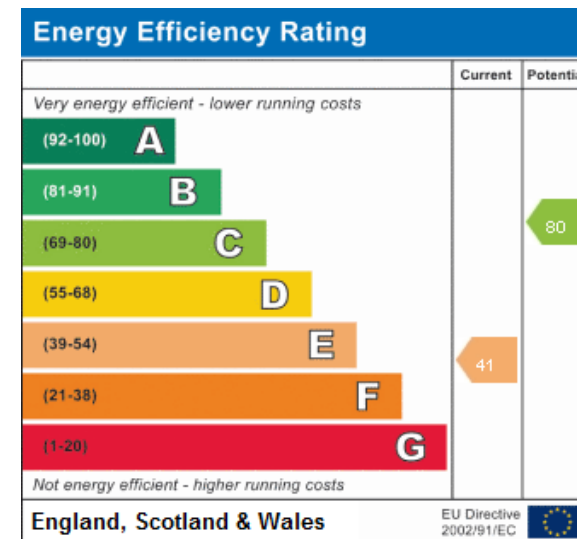

Address:
Park Street

eXp World UK Ltd is a registered company at Level 37, 25 Canada Square, London, E14 5LQ.
Registered company number is 12016573. VAT Registration Number is 327 4120 29