



POWERED BY  
**ROSIE MARLOW exp UK**

@ rosie.marlow@exp.uk.com

rosiemarlow.exp.uk.com

01225 941 008



## Constable Close, Keynsham

£315,000

3 1 2



Please quote reference RM0334. A super Three bedroom terraced home constructed circa 1990 by Crest Nicholson located in a quiet cul de sac. Accommodation includes sitting room, kitchen/ breakfast room, cloakroom and family bathroom. Fantastic rear garden with a large decking area perfect for those evening soirees and off street parking for two vehicles to the front of the home..

The property is located on the Wellsway side of Town and is within comfortable walking distance to Keynsham high street with its plethora of shops, cafes and amenities, the open spaces of the Memorial Park and less than half a mile from the railway station, this property enjoys an excellent location for both families and commuters alike.





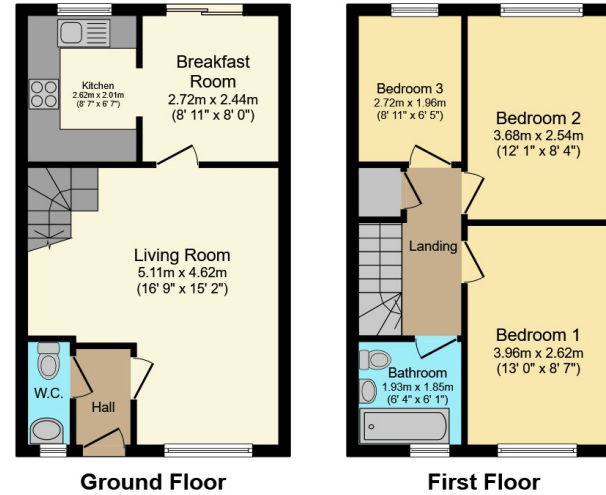

Total floor area 73.0 sq. m. (786 sq. ft.) approx  
 This plan is for illustration purposes only and may not be representative of the property. Plan not to scale. Powered by PropertyBox

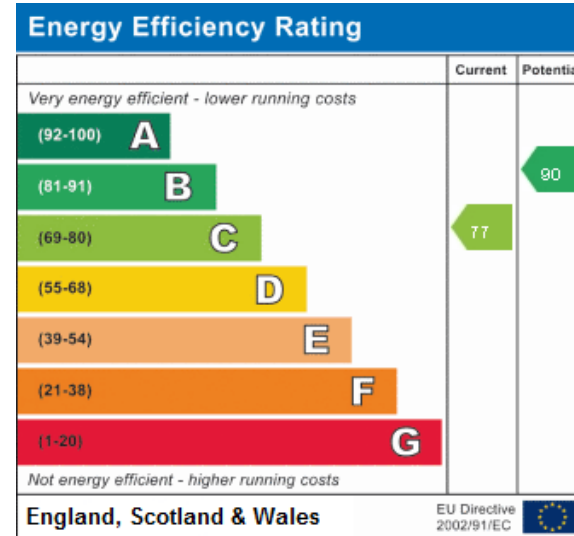

Address:  
 Constable Close