



Woodstone Cottage, Lane Head, Ryton

£400,000

 4  3  2



****WOW**STONE MODERN COTTAGE**FOUR BEDROOMS**THREE BATHROOMS**STUNNING****

This stone cottage was built in 2014 to a high specification with spacious rooms and high quality finishings. The property is self situated in Old Ryton with easy access to local facilities but tucked away off the main road with attractive grey aluminium gated entrance to the courtyard offering plenty of off street parking, with patio areas, a stone storage area, out door fire pit as well as hot tub. Internally it doesn't disappoint, walking into the the stunning spacious lounge with underfloor heating to the timber flooring and spot light features. The centre piece of the

double sided stove in the stone feature chimney breast. There is also a second huge reception room/bedroom that has so many different uses.

Key Features

- Unique Cottage
- Three Bathrooms/WC's
- Immaculately Presented
- Double Sided Log Burning Stove
- Four Bedrooms
- Courtyard Parking with Gated Entrance
- High Specification
- Ref: KH0081



Ground Floor

Floor area 123.0 sq.m. (1,324 sq.ft.) approx

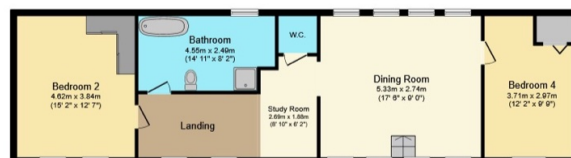

First Floor

Floor area 86.5 sq.m. (932 sq.ft.) approx

Total floor area 209.6 sq.m. (2,256 sq.ft.) approx

This Floor Plan is for illustration purposes only and may not be representative of the property. The position and size of doors, windows and other features are approximate. Unauthorized reproduction prohibited. © PropertyBOX