



Clough Grove, Oughtibridge, S35 0JX

Offers In Region Of £395,000

3 2 2



Why We Love It

Nestled in the heart of Oughtibridge, this property offers the perfect blend of charm and city convenience. Enjoy access to scenic walks, local amenities, and a close-knit community while being just a short journey away from Sheffield's vibrant city life. The property's layout and location make it ideal for modern family living. Clough Grove is a unique opportunity to experience comfort, versatility, and contemporary style.

Why You'll Love It

From the moment you arrive, you'll be captivated by the property's inviting curb appeal and well-maintained front garden. A driveway provides convenient off-road parking, and a converted garage serves as both a dining room and additional storage space. The exterior exudes a warm and welcoming ambiance, reflecting the tranquil surroundings.

Step inside, and you'll find a bright and open interior that conveys comfort and style. The spacious living room is bathed in natural light, offering a cosy atmosphere for relaxation and gatherings. The dining room, cleverly converted from the garage, provides a versatile space for family meals and entertaining, while the storage area ensures that everything has its place. The modern kitchen is the heart of the home, equipped with high-quality appliances, sleek finishes, and ample counter space. Upstairs, you'll discover three generously sized bedrooms, each designed for comfort and functionality. The main bedroom features walk in wardrobes and an ensuite bathroom, offering convenience and privacy. The additional bedrooms provide plenty of room for family members or guests. Completing the floor plan is the generously sized bathroom with attractive corner bath. This home boasts a well maintained and ample sized back garden, with plenty of space for socialising, relaxing and even a play area!



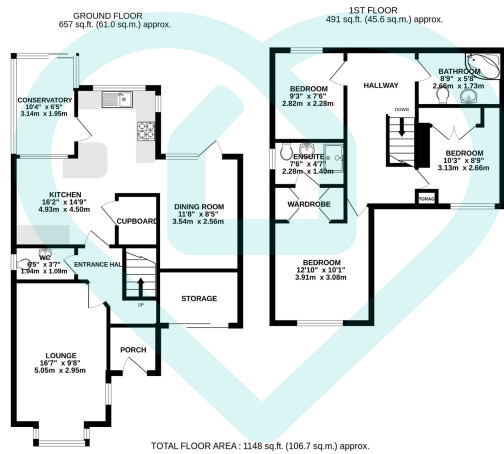

This floor plan is for illustrative purposes only. All measurements and layouts are approximations and do not necessarily capture the precise specifications of the property. No responsibility is taken for any error, omission, or misstatement. We always recommend viewing in person to confirm the exact floor plan of a property. Made with Metropix.



- Drive
- Front and Rear Garden
- Sought After Location
- Great Key Road Access
- Public Transport Links
- Good Range of Local Schools
- Large Living Area
- Well Presented
- Adaptable Space
- Close to Green Space

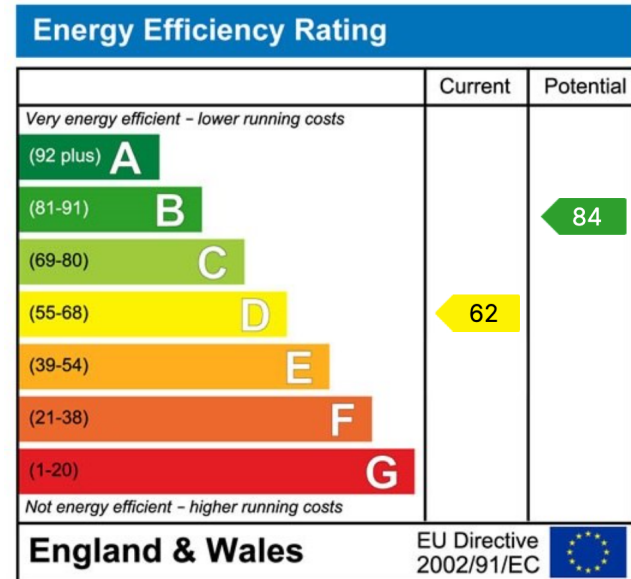

Sales | Lettings | New Homes

VAT Reg Number: 191 3588 84
 Company Reg Number: 08610489
 Company Reg Address: 67 Middlewood Road, Hillsborough, Sheffield, S6 4GX.

The MorfittSmith Building
 67 Middlewood Road
 Hillsborough
 Sheffield
 S6 4GX

Get in touch - arrange an appointment



0114 232 1764
 sales@morfittsmith.co.uk
 lettings@morfittsmith.co.uk
 newhomes@morfittsmith.co.uk
 www.morfittsmith.co.uk



@MorfittSmith
 @MorfittSmith
 MorfittSmith
 Estate & Letting Agent