



Greaves Lane, Stannington, Sheffield, S6 6BE

Offers In Region Of £625,000

🛏️ 4 🚿 2 🛋️ 2



Why we Love It

The whole house is simply beautiful, but for us it's the back garden. A lush and open space which will be perfect for you and your family. With enough room for a play area, furniture and hosting social occasions, we can see this being the hub of the home during the warmer seasons.

Why You'll Love It

Greaves Lane, Stannington sits in a scenic and tranquil location. A detached property with an extensive rear garden for extra privacy. Tucked away from the hustle and bustle of the city, yet surrounding key roads means you still take advantage of all the city has to offer. Boasting a double drive and a garage, as well as a great choice in local schools, Greaves Lane is the perfect family home. The ground floor is made up of a stunning modern kitchen, with ample space and sleek finishings. Here you also have attractive French Doors opening to that fantastic rear garden. Taking you into a separate dining area, which will be perfect for hosting and socialising. Next is the family lounge, a large space finished to an excellent standard, with a large window for that all important natural light. One of the four bedrooms is situated on the ground floor, which has its own ensuite. Finally we have a handy utility room and an additional downstairs washroom. The hallway to the stairs is a beautiful light and open space, with room for storage and even furniture. Heading upstairs, again we have an open and attractive hallway with built in storage. The three remaining bedrooms are situated up here, all of which are great sizes and immaculately presented. These rooms are adaptable to suit your family needs and could easily be used as an office space or a walk-in wardrobe. Completing the floor plan is the family bathroom suite, a large than average bathroom with a shower over the bath.



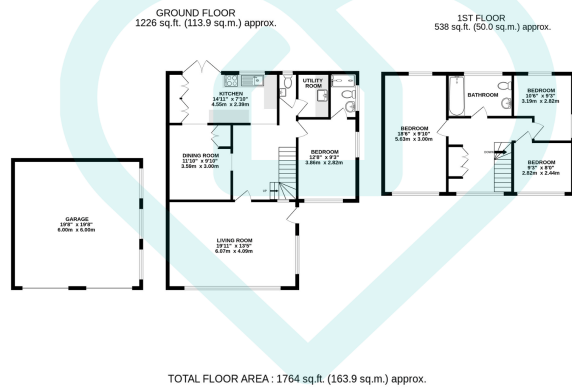

This floor plan is for illustrative purposes only. All measurements and layouts are approximations and do not necessarily capture the precise specifications of the property. No responsibility is taken for any error, omission, or misstatement. We always recommend viewing in person to confirm the exact floor plan of a property. Made with Metropix.



- Large Plot of Land
- Private Road
- Close to Green Space
- Large Garden
- Sizable Drive for Multiple Vehicles
- Peaceful Location
- Immaculately Presented
- Modern Kitchen
- Large Bedrooms
- Garage

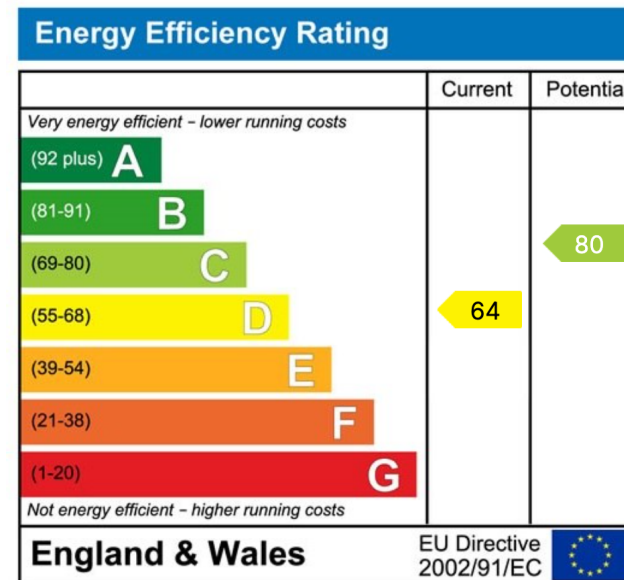

Sales | Lettings | New Homes

VAT Reg Number: 191 3588 84
 Company Reg Number: 08610489
 Company Reg Address: 67 Middlewood Road, Hillsborough, Sheffield, S6 4GX.

The MorfittSmith Building
 67 Middlewood Road
 Hillsborough
 Sheffield
 S6 4GX

Get in touch - arrange an appointment



0114 232 1764
 sales@morfittsmith.co.uk
 lettings@morfittsmith.co.uk
 newhomes@morfittsmith.co.uk
 www.morfittsmith.co.uk



@MorfittSmith
 @MorfittSmith
 MorfittSmith
 Estate & Letting Agent