



Vale Grove, Loxley, S6 6TB
Offers In Region Of £400,000

4 1 2



Why We Love It

The whole house is beautiful but for us it's the back garden! It's a great size with a large grass area and a decking area to the rear. Plenty of room for a play area, furniture, and a BBQ. We can see this being the family hub during the summer seasons!

Why You'll Love It

Vale Grove is an attractive 4-bed home in the peaceful location of Loxley. With a substantial drive, front garden, and a garage to the front of the property. The trees in the front provide privacy from the street. You enter the home via side door opening into a spacious and well decorated hall. With the bright and airy kitchen to the left. Beautifully presented with neutral décor and modern fixtures. A separate dining room sits to the rear, a nice space for hosting family meals. A generous sized lounge sits to the right of the property, again well presented with plenty of room for furniture. Boasting attractive bay window for plenty of natural daylight. Completing the ground floor plan is a handy washroom. Upstairs houses the four bedrooms, each room a good size with neutral décor. Making adding your own stamp to the property all the easier. Completing the floor plan is the 3-piece family bathroom suite. Loxley is a sought after location thanks to its proximity to countryside as well as the City. So, you really do get the best of both Worlds. Key roads allow ease of access into other hot spots such as Hillsborough, Kelham Island and beyond. With a good choice of local school to make the school run all the easier.



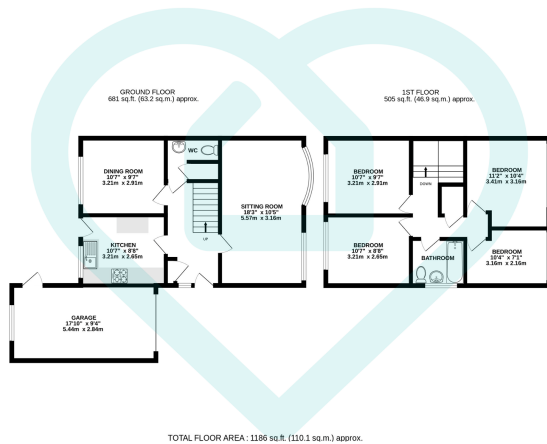

This floor plan is for illustrative purposes only. All measurements and layouts are approximations and do not necessarily capture the precise specifications of the property. No responsibility is taken for any error, omission, or misstatement. We always recommend viewing in person to confirm the exact floor plan of a property. Made with Metropix.



- Attractive Property
- Well Presented
- Sought After Location
- Surrounding Green Space
- Good Sized Rooms
- Extensive Rear Garden
- Drive
- Garage
- Quiet Cul-de-sac
- Key Road Access

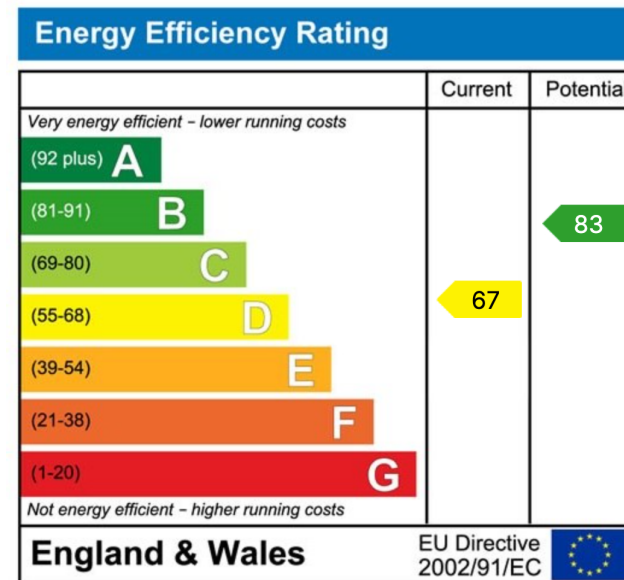

Sales | Lettings | New Homes

VAT Reg Number: 191 3588 84
 Company Reg Number: 08610489
 Company Reg Address: 67 Middlewood Road, Hillsborough, Sheffield, S6 4GX.

The MorfittSmith Building
 67 Middlewood Road
 Hillsborough
 Sheffield
 S6 4GX

Get in touch - arrange an appointment

- 0114 232 1764
- sales@morfittsmith.co.uk
- lettings@morfittsmith.co.uk
- newhomes@morfittsmith.co.uk
- www.morfittsmith.co.uk

- @MorfittSmith
- @MorfittSmith
- MorfittSmith Estate & Letting Agent