



9 Brookside, Temple Ewell

£350,000

DOMINIC MURPHY POWERED BY exp <sup>TM</sup> UK

@ dominic.murphy@exp.uk.com

dominicmurphy.exp.uk.com

01304 746 016

## 9 Brookside, Temple Ewell

ALSO HAS A GARAGE AND LARGE SECRET GARDEN! A wonderful period home, recently modernised to a high specification, in a tucked away position in the heart of the pretty village of Temple Ewell, with wonderful gardens.

A superb house with contemporary and period features that provide a spacious practical two-level layout, including good separation of living areas for maximum entertaining comfort.

**Internally** there is a welcoming hall with access to the dining room and open planned lounge with its feature fireplace. The dining room is an ideal heart and hub of the home with great entertaining space. The fabulous designed quality kitchen is located to the rear and flows nicely to a utility area. Upstairs, to the first floor are two double bedrooms, both bedrooms retaining period fireplaces. There is recently installed quality shower room, which is a very generous sized room..

**Externally**, the property is further enhanced by a large private rear garden which is accessed via the kitchen, it is mainly laid to lawn and bosats a large patio seating area.

**Garage, driveway and plot** The added benefit of owning this property is the garage and driveway with parking for upto 3 vehicles,, which is a major asset being that parking comes at a premium in this area. Behind the garage is a side gate that takes you to a large plot measuring approximately 60" x 60" which could serve a number of uses.











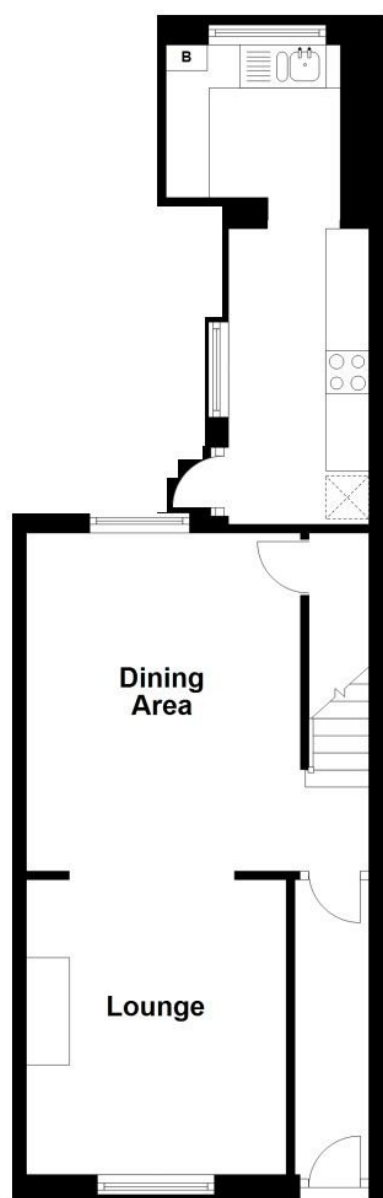

**GROUND FLOOR**



**FIRST FLOOR**