



5, Belmont Villas Gore Road, Eastry

£400,000

DOMINIC MURPHY POWERED BY exp TM UK

@ dominic.murphy@exp.uk.com

dominicmurphy.exp.uk.com

01304 746 016

5, Belmont Villas Gore Road, Eastry

Intro - A wonderful four-bedroom period home, far bigger than it looks from the outside with great entertaining space and a wonderful large garden with a detached studio and garage.

Property - The current owners have loved home from day one and have made vast improvements over the years, whilst maintaining the feeling of a lovely property for any future family or couples. The interior includes a hall with doors into a front lounge complete with log burner. To the rear is a separate good size dining room with feature fireplace, lending itself to a perfect family hub. This room flows into the generous size well-appointed kitchen at the rear, which has a generous number of units and appliances, doors lead out to the rear patio. Also off the dining room is the handy conservatory.

A staircase takes you up to the first-floor landing area with two double bedrooms and a smaller third, the family bathroom is a quality four-piece suite, complete with bath and shower cubicle. A further staircase takes you up to a loft extension that boasts a further bedroom, a shower room and a landing that works well as a small study area.

Outside: The rear garden is mainly laid to lawn with patio seating area for enjoying al fresco dining in the summer months with a matching path that leads to the fully equipped studio/cabin (3m x 4m). The rear of the studio and access via Wilmott Place is the added benefit of a detached single garage.









GROUND FLOOR
696 sq.ft. (64.7 sq.m.) approx.

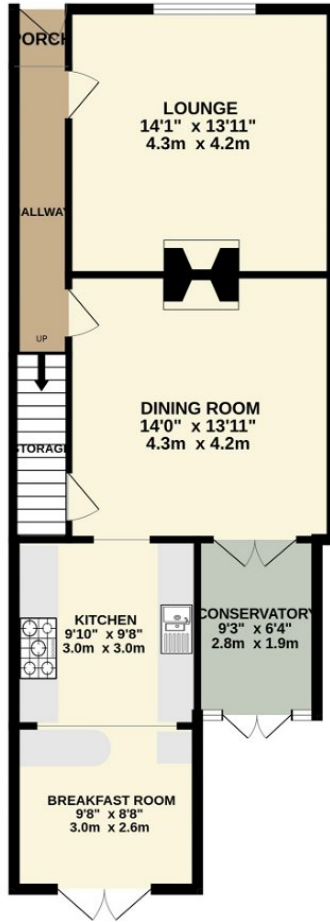

1ST FLOOR
555 sq.ft. (51.6 sq.m.) approx.

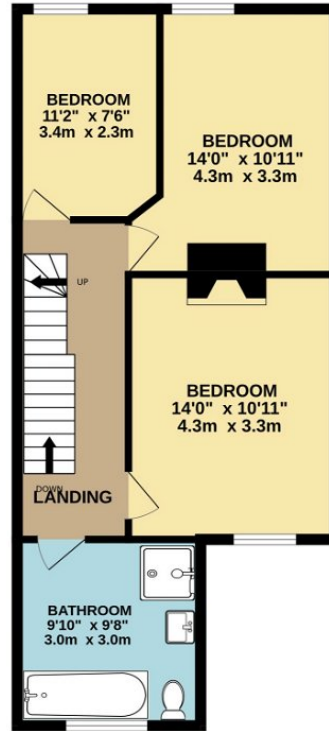

2ND FLOOR
261 sq.ft. (24.2 sq.m.) approx.

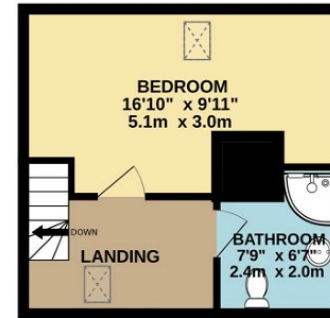

TOTAL FLOOR AREA : 1512 sq.ft. (140.5 sq.m.) approx.

Whilst every attempt has been made to ensure the accuracy of the floorplan contained here, measurements of doors, windows, rooms and any other items are approximate and no responsibility is taken for any error, omission or mis-statement. This plan is for illustrative purposes only and should be used as such by any prospective purchaser. The services, systems and appliances shown have not been tested and no guarantee as to their operability or efficiency can be given.

Made with Metropix ©2024

eXp World UK Ltd is a registered company at Level 37, 25 Canada Square, London, E14 5LQ.

Registered company number is 12016573. VAT Registration Number is 327 4120 29