

DOMINIC MURPHY
exp UK
01304 746 016
DOMINICMURPHY.EXP.UK.COM
FOR SALE



15 Woodnesborough Road

£475,000

DOMINIC MURPHY POWERED BY exp UK

@ dominic.murphy@exp.uk.com

dominicmurphy.exp.uk.com

01304 746 016

15 Woodnesborough Road

Introduction - An attractive detached home positioned on the town end of Woodnesborough road, tastefully decorated with plenty of family space, sitting on a generous tucked away plot with lots of potential. Please quote reference DM0223

Main accommodation - As you enter the property via the welcoming front porch, a further door takes you into the newly decorated entrance hall with doors that open into a brand-new wet room with wc at the front. The generous size front lounge is a double aspect room with window to both front and side. Central folding doors open widely into the dining room, creating a good separation of living spaces for maximum family comfort if needed. On a particular note, new flooring covering has been fitted to both hallway, lounge, and dining areas. From the dining room is the generous size conservatory at the rear. The quality fitted kitchen has plenty of worktop and storage unit space and is a great family central hub. Upstairs, there are also three generous size bedrooms that share the quality four-piece bathroom suite. On a particular note the master bedroom, benefitting from a walk-in wardrobe and direct access into the family bathroom.

Gardens - Double gates at the top of the drive open into the off-street parking leading to the detached garage. There are generous size front and rear gardens to include extensive terracing and lawned areas, with areas for entertaining and al-fresco dining.











GROUND FLOOR
APPROX. FLOOR
AREA 679 SQ.FT.
(63.1 SQ.M.)

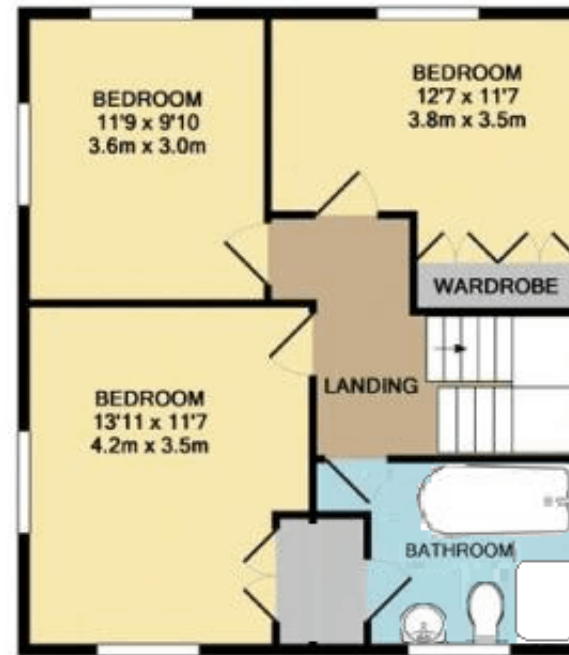

1ST FLOOR
APPROX. FLOOR
AREA 570 SQ.FT.
(53.0 SQ.M.)

TOTAL APPROX. FLOOR AREA 1249 SQ.FT. (116.1 SQ.M.)

Whilst every attempt has been made to ensure the accuracy of the floor plan contained here, measurements of doors, windows, rooms and any other items are approximate and no responsibility is taken for any error, omission, or mis-statement. This plan is for illustrative purposes only and should be used as such by any prospective purchaser. The services, systems and appliances shown have not been tested and no guarantee as to their operability or efficiency can be given.

Made with Metropix ©2014

eXp World UK Ltd is a registered company at Level 37, 25 Canada Square, London, E14 5LQ.

Registered company number is 12016573. VAT Registration Number is 327 4120 29