



Portland Rise, Corsham

£525,000

🛏️ 4 🚿 2 🚗 1



A fabulous 4 bedroom modern home, built just 6 years ago by Cotswold Homes to a very high specification. A larger than average rear garden compliments the spacious interior and additional bonuses such as a study and utility room give this home a special feel. Located on the edge of the town centre, nothing is more than a 1 mile walk away yet with the countryside right on your doorstep, you can have the best of both worlds.



01225 705650



hello@jainewhitfield.co.uk



www.jainewhitfield.co.uk





- A perfect 4 double bedroom family home
- Excellent kitchen/diner with utility
- Additional study downstairs
- Generous landscaped garden to the rear
- Within 1 mile of Corsham high street with countryside walks on the doorstep
- Rarely available on Portland Rise
- Living room with French doors to the garden
- High specification finish throughout
- Garage and driveway parking
- Sellers have found with complete chain above

Portland Rise, Corsham, SN13

Approximate Area = 1240 sq ft / 115.1 sq m

Garage = 203 sq ft / 18.8 sq m

Total = 1443 sq ft / 133.9 sq m

For identification only - Not to scale

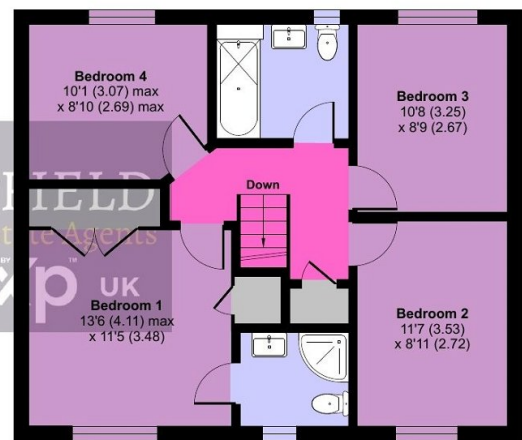

Floor plan produced in accordance with RICS Property Measurement Standards incorporating International Property Measurement Standards (IPMS2 Residential). © nichecom 2024. Produced for Jaine Whitfield Property Services. REF: 1087719



01225 705650



hello@jainewhitfield.co.uk



www.jainewhitfield.co.uk

