



JAMIE COTTON POWERED BY **exp**™ **UK**

@ [jamie.cotton@exp.uk.com](mailto:jamie.cotton@exp.uk.com)

[jamiecotton.exp.uk.com](http://jamiecotton.exp.uk.com)

📞 01562 261 022

# The Close, Hunnington, Halesowen, WORCESTERSHIRE, B62 0JP

Offers In Region Of £375,000

3 1 2

- QUOTE JC0304
- EXCELLENT TRANSPORT AND COMMUTING LINKS
- NEW COMBI BOILER INSTALLED SEPT 22
- FAR REACHING COUNTRYSIDE VIEWS TOWARDS CLANT HILLS
- SOUGHT AFTER SCHOOL CATCHMENT
- NO UPWARD CHAIN



“COUNTRYSIDE VIEWS, SOUGHT AFTER SCHOOL CATCHMENT & EXCELLENT TRANSPORT LINKS ON OFFER WITH NO UPWARD CHAIN” A rare opportunity to purchase an extended and adapted 3-bedroom semi-detached property on a substantial plot in a desirable cul-de-sac with far-reaching views towards the Clent National Trust Hills. In addition to this, the property boasts excellent transport links, Hunnington is nestled away between Junction 3 and 4 of the M5 national motorway network and is 3 minutes from the Hagley Road, a main arterial road into Birmingham City Centre. The property is the catchment for extremely sought-after primary and secondary schools; Romsley’s St. Kenelms CofE and Haybridge High School & Sixth Form. Neighbouring Romsley, Hunnington, has access to all of their amenities including but not limited to two wonderful pub/eateries, hairdressers, coop/post office, award-winning butchers and the local café and country store.



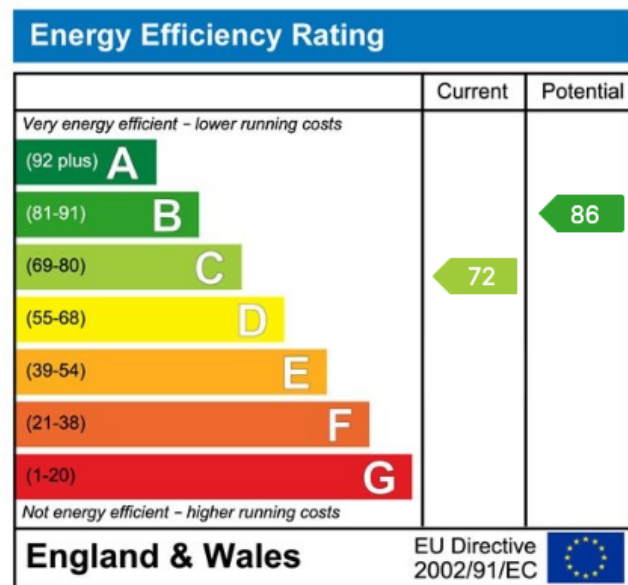
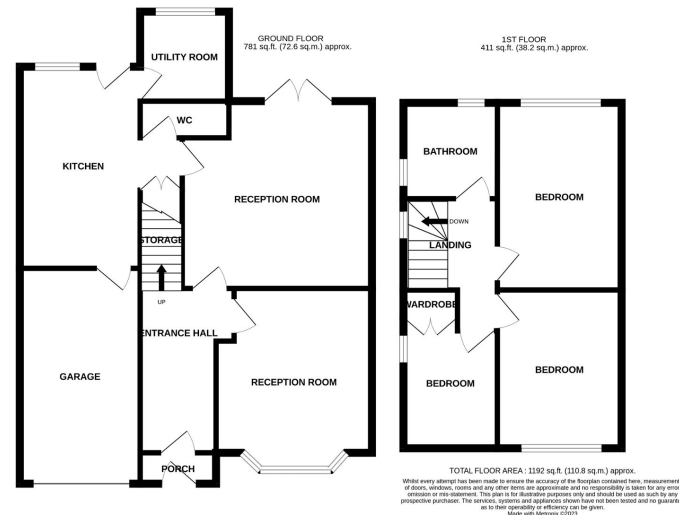

eXp World UK Ltd is a registered company at Level 37, 25 Canada Square, London, E14 5LQ.  
Registered company number is 12016573. VAT Registration Number is 327 4120 29