



JAMIE COTTON POWERED BY **exp** TM UK

@ [jamie.cotton@exp.uk.com](mailto:jamie.cotton@exp.uk.com)

[jamiecotton.exp.uk.com](http://jamiecotton.exp.uk.com)

☎ 01562 261 022

## Ashmead Drive, Cofton Hackett, Birmingham, B45 8AB

Offers In Region Of £400,000

3 1 2

- QUOTE JC0304
- BEAUTIFUL FEATURES AND CHARM THROUGHOUT
- EXTENDED WITH FURTHER POTENTIAL TO EXTEND AND ADAPT (STUC'S)
- LOG BURNER
- LANDSCAPED REAR GARDEN
- AMPLE OFF ROAD PARKING
- FOOT OF THE LICKEY HILLS
- GREAT TRANSPORT LINKS



**"ALL THE BEAUTY AND CHARM ON ASHMEAD DRIVE"** Nestled at the foot of the Lickey Hills this three bedroom semi detached property ticks all the boxes and is available with **NO UPWARD CHAIN**. Already extended to the rear the property boasts even more potential to extend and adapt subject to the usual conditions, oozing character with original and adapted features throughout including parquet flooring, lead lined stain glass windows, original stripped back doors, feature fires and exposed brick open hearth log burner.



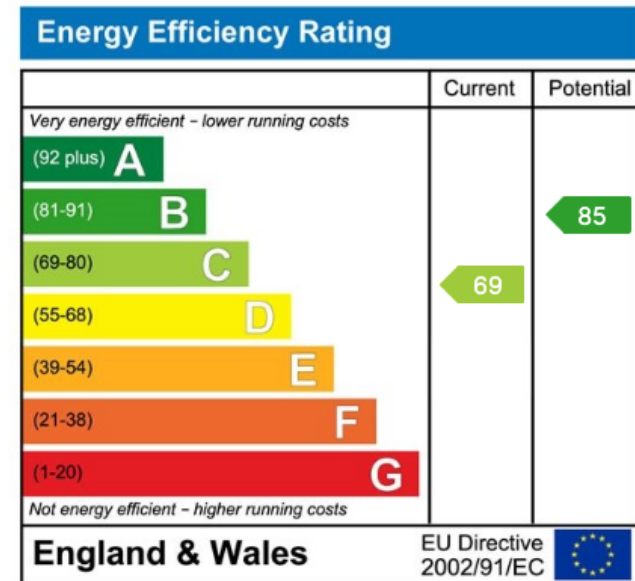
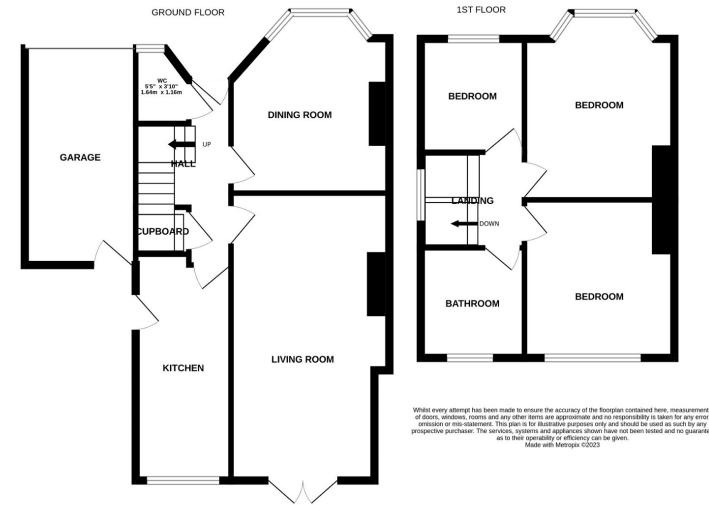

eXp World UK Ltd is a registered company at Level 37, 25 Canada Square, London, E14 5LQ.  
 Registered company number is 12016573. VAT Registration Number is 327 4120 29