



CHRIS MACSWEENEY POWERED BY **exp** TM UK

@ [chris.macsweeney@exp.uk.com](mailto:chris.macsweeney@exp.uk.com)

[chrismacsweeney.exp.uk.com](http://chrismacsweeney.exp.uk.com)

☎ 07468 48 88 18

# Regent Street, Stotfold, Hitchin, SG5 4ED

£379,995

3 2 2

- Sympathetically Refurbished 1920's Character Semi Detached
- Separate Bay Fronted Lounge
- Recently Fitted Bathroom
- Summerhouse/Office in the Garden
- Good Sized Rear Garden and Off Road Parking to the Front
- Open Plan Kitchen/Diner With Original Feature Fireplace and Replacement Kitchen/Lobby Appliances
- Three Bedrooms, Cloakroom
- Fully Renewed Wiring, Heating and Plastering
- Quote Reference CM0245



**\*\* PRICED TO SELL! \*\*** A recently refurbished 1920's semi detached family home offered with no upward chain. This delightful character home has undergone a beautiful restoration and refurbishment to include the installation of a gas central heating system and a full rewire and re-plastering, whilst also retaining some original character features including fireplaces and bannister rails. Accommodation includes a large and recently fitted open plan kitchen/diner, separate bay fronted lounge, recently installed bathroom, utility/lobby, cloakroom and three bedrooms. Outside offers a garden approaching 45ft in length and includes a new summerhouse which could have further use as an office or other facility. Parking to the front for up to two vehicles. Viewing is essential. Quote reference CM0245.



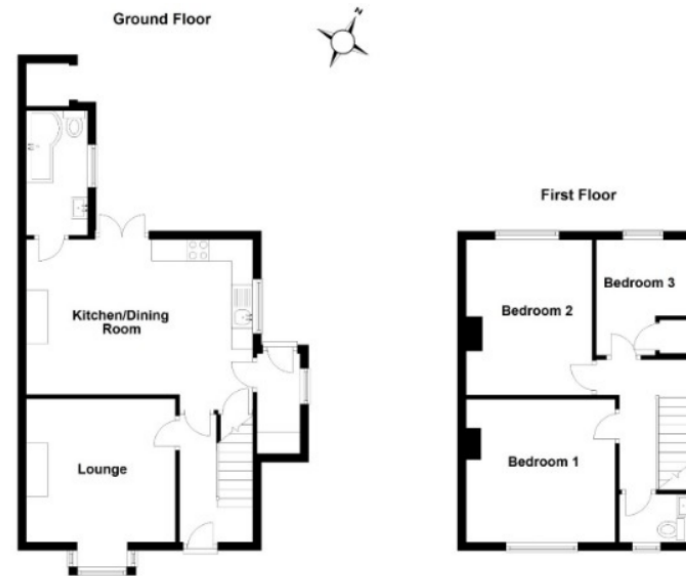

Total area: approx. 83.4 sq. metres (897.9 sq. feet)



Score	Energy rating	Current	Potential
92+	A		
81-91	B		83 B
69-80	C		
55-68	D	61 D	
39-54	E		
21-38	F		
1-20	G		

eXp World UK Ltd is a registered company at Level 37, 25 Canada Square, London, E14 5LQ.

Registered company number is 12016573. VAT Registration Number is 327 4120 29