

## Marwood Close, Wymondham, Norfolk , NR18 0TX

£220,000

2 bedrooms, 1 bathroom, 0 parking spaces



This semi detached 2 bedroom house offers approximately 650 sq ft of living space and would be the perfect home for a single person or parent looking to benefit from sought after local schools, a young or elderly couple looking for easy access to the town centre and all its amenities and easy access to Norwich, Cambridge and London via road or rail. The property is well presented throughout and sits in a quiet cul de sac close, sitting on a generous plot 90ft x 15ft with a rear fully enclosed garden approximately 35ft x 15ft, front garden 30ft x 15ft and off road parking for 2 cars. There is no forward chain so a quick sale would be possible.

**Tenure: Freehold EPC: C Council Tax: B**

## Key Features

- More photos coming soon !!!
- Minutes from the towns railway station with regular services to Norwich and Cambridge
- Close to sought after local schools, clubs and societies
- Sitting on a generous plot 90ft x 15ft with a 30 ft front garden and 35ft rear garden
- The perfect home for first time buyers, young / elderly couple, or investors
- Two bedroom terrace house in popular location
- Walking distance from the town centre with all its amenities
- Offering approximately 650 sq ft of living space
- Allocated parking for two cars to the rear of the property
- Freehold, EPC C, Council tax B

GROUND FLOOR

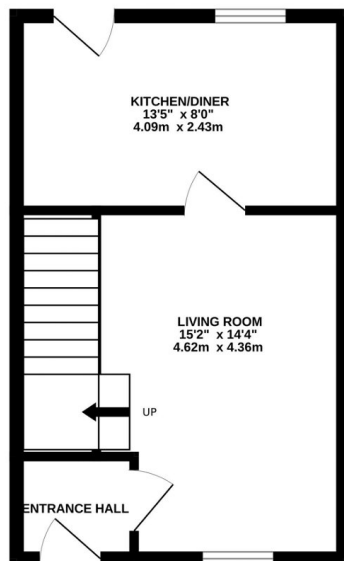

1ST FLOOR

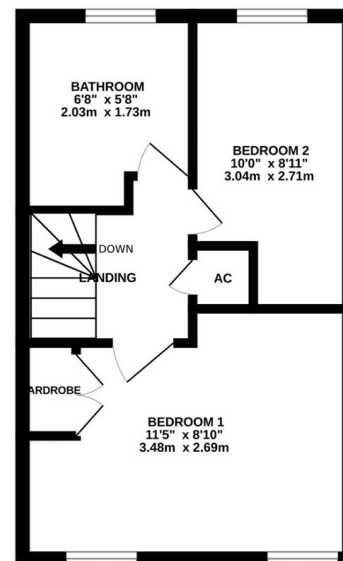

Whilst every attempt has been made to ensure the accuracy of the floorplan contained here, measurements of doors, windows, rooms and any other items are approximate and no responsibility is taken for any error, omission or mis-statement. This plan is for illustrative purposes only and should be used as such by any prospective purchaser. The services, systems and appliances shown have not been tested and no guarantee as to their operability or efficiency can be given.  
Made with Metropix ©2024