

Stile Lane, Wymondham, Norfolk

Offers In Region Of £525,000

4 2 2

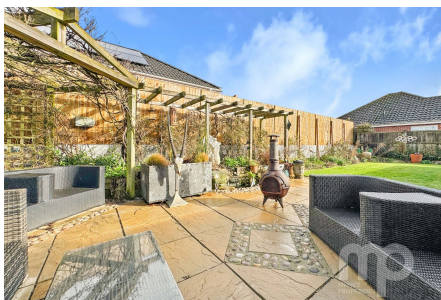

Moneyproperties introduce this spacious and versatile detached three-bedroom bungalow, complete with a one-bedroom annexe, offering a combined living space of approximately 1600 sq ft. The annexe presents a fantastic opportunity for rental purposes, adding further value to this already remarkable property. Recently upgraded with new double glazed windows and solar panels and sitting on a generous plot 95ft x 75ft approximately 0.16 acre with ample parking

Tenure: Freehold EPC: B Council Tax: D

Key Features

- Spacious and versatile detached three bedroom bungalow with one bedroom annexe
- Walking distance from the town centre with all its amenities including regular bus and rail services
- Outbuildings include garage 15ft 8in x 14ft 7in, storage shed 14ft 2in x 5ft 5in and a wood shed 6ft x 6ft
- Must view to fully appreciate / motivated sellers / viewing strictly by appointment as on private road
- Easy access to the main A11 for those commuting to work in Norwich and Cambridge
- Offering approx 1600 sq ft of living space, including annexe which could be incorporated back into the main house.
- Sitting on a generous plot 95ft x 75ft approximately 0.16 acre with ample parking
- Recently upgraded with new double glazed windows and solar panels
- Minutes from sought after local schools and Wymondham Leisure centre with swimming pool and gymnasium
- Freehold, EPC B, Council Tax D

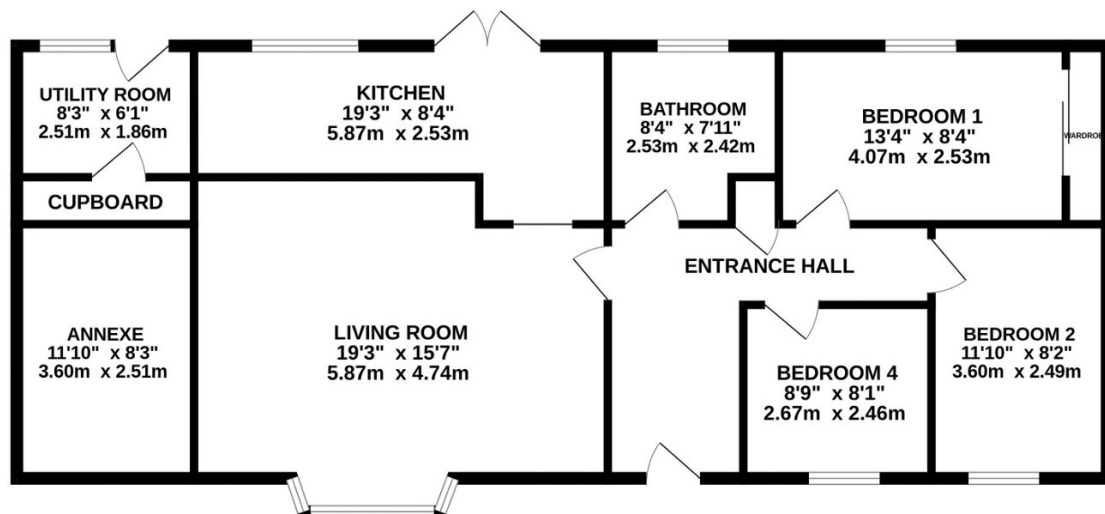

Whilst every attempt has been made to ensure the accuracy of the floorplan contained here, measurements of doors, windows, rooms and any other items are approximate and no responsibility is taken for any error, omission or mis-statement. This plan is for illustrative purposes only and should be used as such by any prospective purchaser. The services, systems and appliances shown have not been tested and no guarantee as to their operability or efficiency can be given.
Made with Metropix ©2024