

The Street, Ashwellthorpe, Norwich, NR16 1AA

Offers In Region Of £250,000

🛏 2 🍷 1 🚗 2



Introducing this fantastic renovation opportunity presented by Moneyproperties, a detached two-bedroom bungalow located on a substantial plot measuring approximately 200ft x 50ft, equivalent to an impressive 0.23 acres. With a focus on renovation, this property offers endless possibilities and potential for those looking to create their dream home.

Tenure: Freehold EPC rating: D Council tax band: C

Key Features

- Detached two bedroom bungalow sitting on a generous 200ft x 50ft (0.22 acre)
- Huge potential but in need of revovation hence the price
- Opportunity to extend to the side and rear subject to appropriate planning permission
- Currently offering approximately 1000 sq ft of living space, garage and various outbuildings
- Sought after village ten minutes from the Norfolk market town of Wymondham with all its amenities
- Well placed for the Norfolk market towns of Attleborough and Diss both with regular rail services to Cambridge and Easdean
- Minutes from sought after schools such as Wymondham High and Wymondham College
- Easy access to the main A11 and A47 for those commuting by road
- Only a 25 minute drive to the City of Norwich
- No forward chain / quick sale possible
- EPC rating TBC Council tax band C

GROUND FLOOR

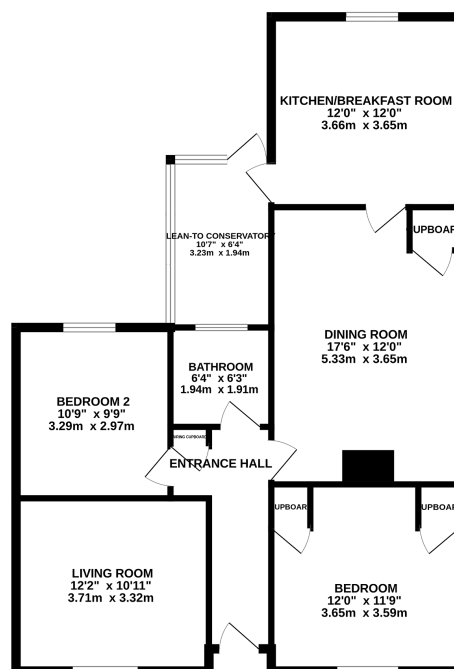

Whilst every attempt has been made to ensure the accuracy of the floorplan contained here, measurements of doors, windows, rooms and any other items are approximate and no responsibility is taken for any error, omission or mis-statement. This plan is for illustrative purposes only and should be used as such by any prospective purchaser. The services, systems and appliances shown have not been tested and no guarantee is to their operability or efficiency can be given.
Made with Metropac C2024