

Bush Road, Hellesdon, NR6

Offers In Region Of £270,000

2 1 2



Moneyproperties proudly present this semi detached two bedroom bungalow extended to the rear to provide a dining room, and offering 1000sq ft of living space. Sitting on a generous plot 165ft x 35ft with 110ft rear south facing garden. 75ft drive and garage allowing parking for 4/5 cars. Recently updated wet room. There is no forward chain so a quick sale would be possible.

Tenure: Freehold EPC: C Council Tax: C

Key Features

- Semi detached two bedroom bungalow in a quiet cul de sac
- Extended to provide dining room to the rear of the property
- Sitting on a generous plot 165ft x 35ft with 110ft rear south west facing garden
- Close to all the local amenities including Hellesdon Community centre
- Easy access to the main A47 for those commuting by car
- Offering approximately 1000 sq ft of living space
- Bathroom recently updated with a wet room
- 75ft drive and garage allowing parking for 4/5 cars
- Minutes from the Norwich International Airport and City centre
- No forward chain / quick sale possible

GROUND FLOOR

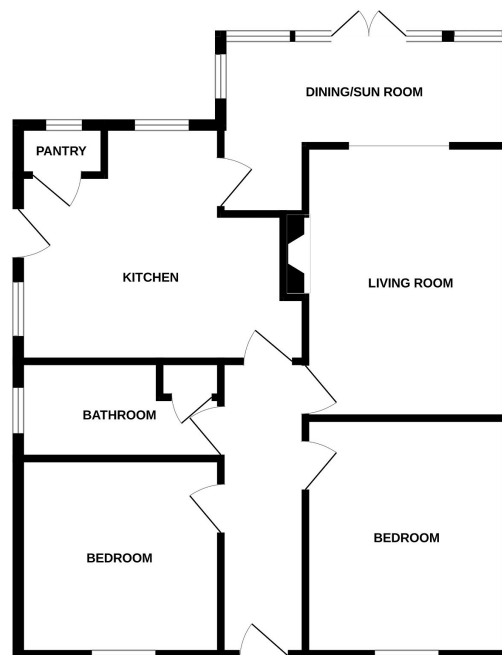

Whilst every attempt has been made to ensure the accuracy of the floorplan contained here, measurements of doors, windows, rooms and any other items are approximate and no responsibility is taken for any error, omission or mis-statement. The plan is for illustrative purposes only and should be used as such by any prospective purchaser. The services, systems and appliances shown have not been tested and no guarantee as to their quality or efficiency can be given.
Made with Metropix ©2024