

The Street, Ashwellthorpe, NR16

£550,000

5 2 2



Moneyproperties are delighted to bring to market this executive style five-bedroom house located in the popular village of Ashwellthorpe just outside of Wymondham. No forward chain and comprising of an entrance hall, 24ft living room with wood burning stove, modern kitchen, dining room leading to the spacious conservatory, utility and downstairs wc. Upstairs comes a generous master bedroom with a walk-in wardrobe and ensuite, four additional well-proportioned bedrooms and a separate shower and bathroom. Outside the property benefits from an integral garage, carport, ample off-road parking and a 68ft rear garden with a brick outbuilding.

Tenure: Freehold EPC: E Council Tax: D

Key Features

- Executive style five bedroom detached house
- Stylish and modern interior throughout
- Large master bedroom with walk in wardrobe and ensuite
- Integral garage with additional carport and ample off-road parking
- No onward chain!!
- 24ft living room with feature wood burning stove
- Generous conservatory enjoying views of the rear garden
- Located in the popular village of Ashwellthorpe
- 68ft rear garden with brick built outbuilding
- EPC E, Council Tax Band D

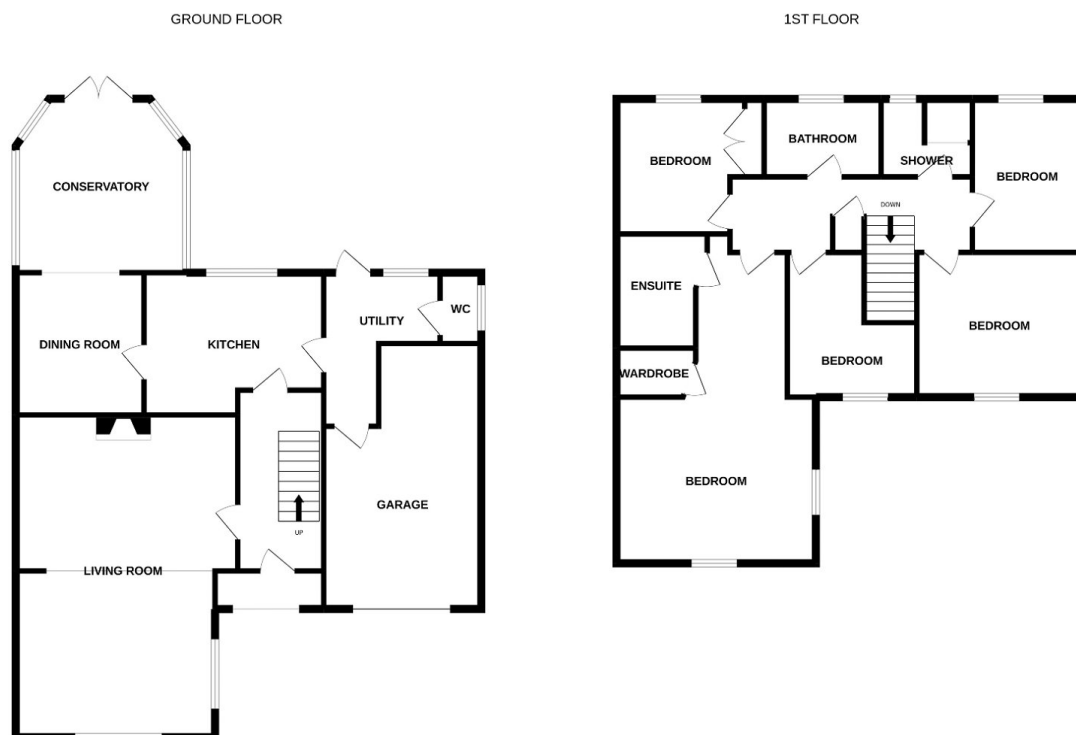

Whilst every attempt has been made to ensure the accuracy of the floorplan contained here, measurements of doors, windows, rooms and any other items are approximate and no responsibility is taken for any error, omission or mis-statement. This plan is for illustrative purposes only and should be used as such by any prospective purchaser. The services, systems and appliances shown have not been tested and no guarantee as to their operability or efficiency can be given.
Made with Metropix ©2022