

Maple Grove, Ivybridge, Devon

Offers In Region Of £335,000

3 2 1



- Semi Detached House
- Three Double Bedrooms
- Ensuite & Family Bathroom
- Generous Level Garden
- Completed in 2022
- Double Length Driveway
- Open Outlook Creating of Space
- No Onward Chain
- Kitchen/Dining Room
- Cloakroom/WC

6 Maple Grove, Ivybridge, PL21 0ZD

Approximate Gross Internal Floor Area = 99.3 sq m / 1069 sq ft

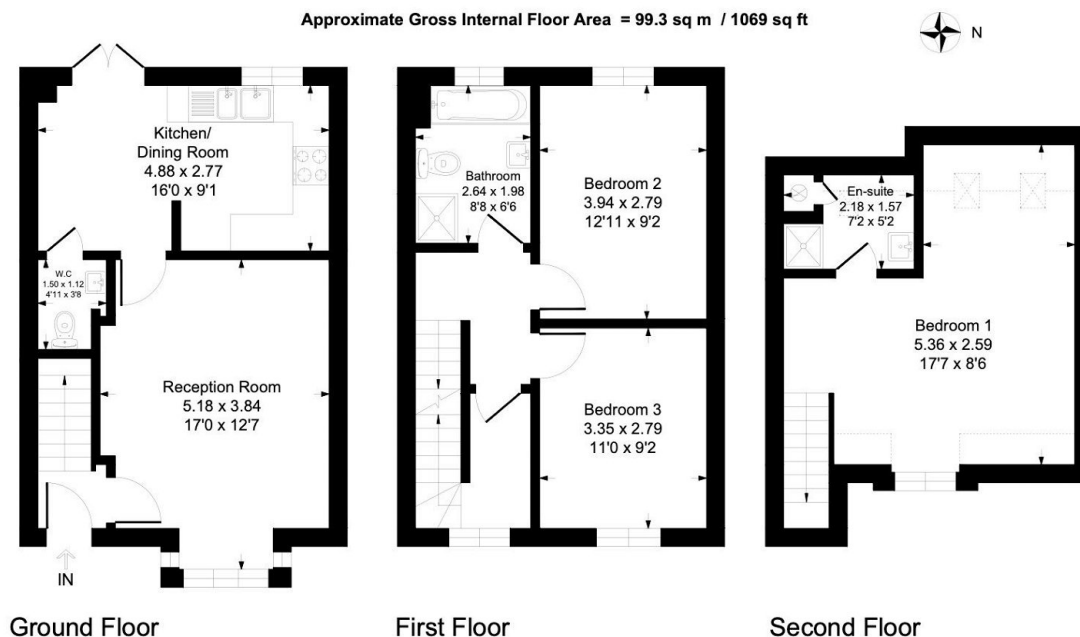

Illustration for identification purposes only, measurements are approximate, not to scale.

Located in the sought-after Saxon Gate development, this charming semi-detached house offers modern comfort and convenience. Upon entering, you are welcomed into an inviting entrance hallway that leads to a spacious lounge, perfect for relaxing or entertaining guests. The bright and airy kitchen/dining room, a perfect space for cooking and enjoying meals with loved ones. This well-appointed property boasts three double bedrooms, with the master bedroom featuring an ensuite shower room for added privacy and convenience, while a family bathroom serves the remaining bedrooms. Outside, a double-length driveway offers plenty of parking space,

complemented by a level rear garden ideal for outdoor activities and al fresco dining. The property's pleasant outlook to both the front and back creates the feeling of space. With the added benefit of no onward chain, this two-year-old semi-detached house is ready to become your new home.