

Villiers Close, Plymstock, Plymouth

Guide Price £320,000

2 1 1



- Detached Bungalow
- Double Glazed Windows and Doors
- Single Detached Garage
- No Onward Chain
- Modern Bathroom
- Two Bedrooms
- Ample Parking
- Corner Plot with Generous Garden
- Fitted Kitchen/Dining Room
- Agent Reference HM0163

GROUND FLOOR

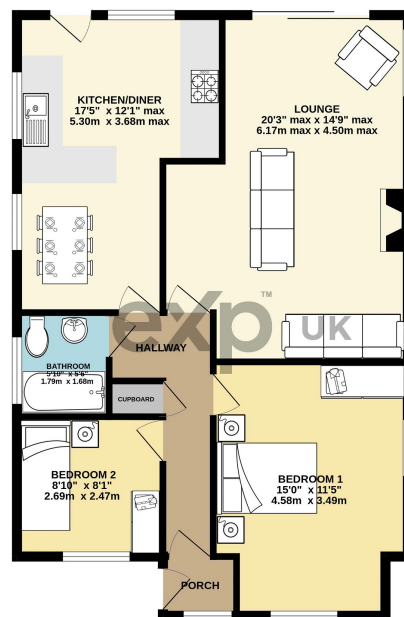

While every attempt has been made to ensure the accuracy of the floorplan contained here, measurements of doors, windows, rooms and any other items are approximate and no responsibility is taken for any error, omission or misstatement. This plan is for illustrative purposes only and should be used as such by any prospective purchaser. The services, systems and appliances shown have not been tested and no guarantee as to their operability or efficiency can be given.
Made with floorplan 10/2020

Welcome to this charming, detached bungalow with two bedrooms situated on a corner plot with a generous garden. This property offers ample parking with convenient access to the drive at either end, a detached single garage, and the added benefit of no onward chain. The bungalow features double-glazed windows and doors, as well as gas central heating powered by a new gas boiler, ensuring comfort and energy efficiency throughout the year. The lounge boasts a cosy fireplace, creating a warm and inviting atmosphere. The fitted kitchen and dining room provide a delightful space for preparing meals and entertaining guests. The property also offers a stylish

and contemporary bathroom, adding to the overall appeal of the bungalow. Outside, the corner plot boasts a generous garden, providing plenty of space for outdoor activities, gardening, or simply enjoying the fresh air. The detached single garage and ample parking ensure convenience and ease. Reference HM0163