



Your Logo

## MEDDINS LANE, Kinver, DY7 6BZ

Offers In Region Of £629,950

🛏️ 4 🚿 2 🛋️ 2

- A most impressive, thoughtfully extended FOUR BEDROOM DETACHED FAMILY HOME
- Stunning Breakfast Kitchen to the rear.
- Utility Room and a downstairs cloakroom.
- Modern Family Shower Room.
- Within walking distance of local schooling, scenic walks and having Kinver Edge on the doorstep - an early viewing is advised.
- Offering modern contemporary living throughout.
- Large Lounge/Diner, separate Sitting Room.
- Stunning Master Bedroom having a unique open plan Ensuite to the side.
- Stunning Rear Garden having a useful outbuilding, lending itself to a variety of uses.
- EPC Rating TBC.



A most impressive, thoughtfully extended FOUR BEDROOM DETACHED FAMILY HOME, occupying this sought after location within Kinver in walking distance of local schooling and having Kinver Edge on its doorstep. Offering contemporary spacious living accommodation to include a large Lounge/Diner, separate Sitting Room, a most splendid extended Breakfast Kitchen, a Utility Room, Bedroom One having a unique open plan Ensuite with feature shower and a bath. There is also separate Modern Shower Room. To the Rear is a wooden framed building, perfect for those that work from home. A early and internal viewing is a must to appreciate the quality of the family home on offer.



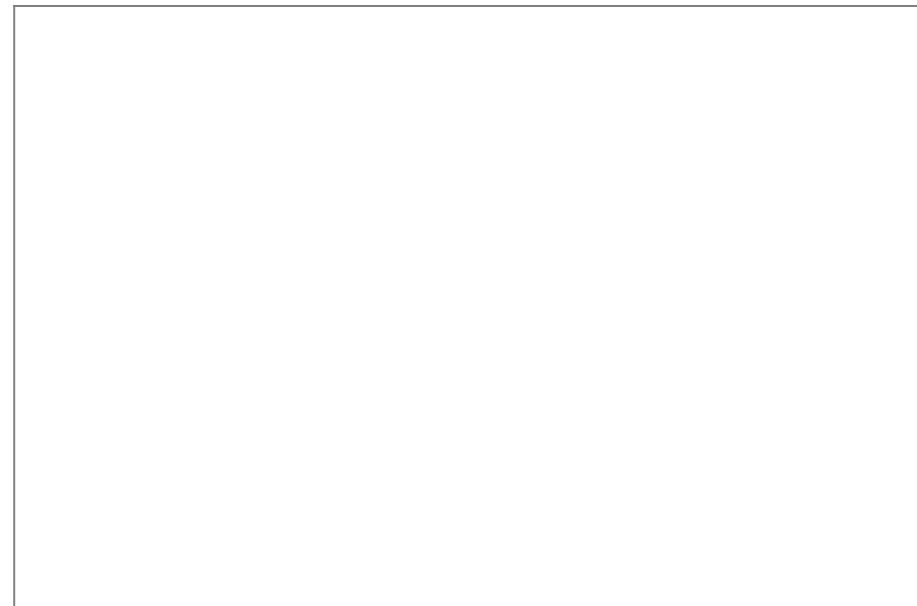
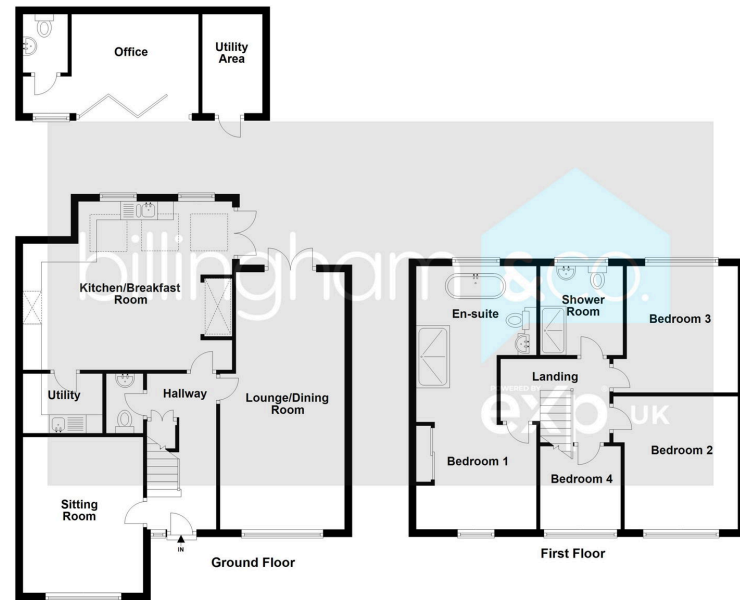

Sales 01384 444 004 / Lettings 01384 445 075  
 hello@billingham.properties  
 www.billingham.properties



Agents Note: Whilst every care has been taken to prepare these particulars, they are for guidance purposes only. All measurements are approximate and are for general guidance purposes only and whilst every care has been taken to ensure their accuracy, they should not be relied upon and potential buyers are advised to recheck the measurements.