



ANDREW  
**DOWNING**  
**BOOTH**™  
ESTATE AGENTS



# Bradley Lakes, Longdon, Rugeley

£950,000

5 4 2





**STUNNING 3.4 ACRE PLOT** - An extremely rare opportunity for a substantial, beautifully presented five/six bedroom detached home, set well back from the road upon a magnificent plot. This magnificent property boasts an endless list of fantastic features, from the choice of four bathrooms, to having separate very large living and dining rooms and impeccably maintained gardens.

Nestled up its own private drive behind wrought iron gates, the property benefits from occupying a truly substantial 3.4 acre plot, consisting of 0.74 acre main gardens and 2.66 acre paddocks (approx), with the immediate gardens housing a large detached double garage with a sizeable adjoined store. The accommodation is set across two floors, with a spacious entrance hall, living room, dining room, kitchen/diner, utility room, office, bathroom and bedroom five all to the ground floor, whilst the four remaining double bedrooms (Master and bedroom two both with en-suite) and Jack & Jill bathroom sit to the first.

This really is just about the complete property, offering an abundance of living space, bedroom space and land whilst not remotely compromising on presentation and quality throughout. A viewing is imperative to appreciate just how much is on offer.



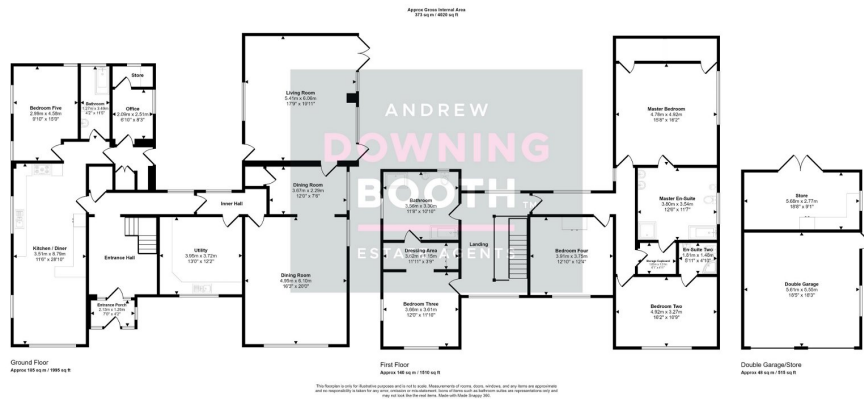

- Sitting In An Incredible Plot Of Approximately 3.4 Acres, Consisting Of Gardens Of Set Back 74 Feet With Private Driveway & 266 Gardens
- Exceptional Living Space
- Desirable & Rural Location
- EPC Rating: TBC
- Substantial Five / Six Bedroom Detached Property
- Detached Double Garage With Large Additional External Store
- Stunning Master Bedroom With Built In Wardrobes & Fantastic En-Suite Bathroom
- Two En-Suites, Ground Floor Bathroom & Jack & Jill First Floor Bathroom
- Council Tax Band: G

