



ANDREW
DOWNING
BOOTH™
ESTATE AGENTS

Thropp Close, Darwin Park, Lichfield

Offers Over £390,000

3 2 2



A fabulous opportunity for a spacious three bedroom home in one of Lichfield's most sought after locations, with the rare added benefit of having no upward chain. This impressive detached property in Thropp Close nestles within a quiet part of Darwin Park and comes to the market with plenty to say for itself, from having a large and airy dual aspect living room, to the three good size bedrooms and private rear garden.

Location-wise, Darwin Park is one of Lichfield's most sought after areas, with the city centre just a short way away and various other amenities sitting locally, such as highly rated schools, Lichfield City train station, Beacon Park and Lichfield Cathedral.

The accommodation is set across two floors, with an entrance hall, dual aspect living room, dining room, kitchen and guest WC all to the ground floor, whilst the three good size bedrooms (Master with ensuite) and main bathroom occupy the first. Externally, a spacious driveway and adjoined garage is complimented by an attractive and private rear garden.

A detached property with generous living and bedroom space in a highly desirable area, you'd be forgiven for expecting a much higher price tag; we must advise booking in a viewing at your earliest convenience.



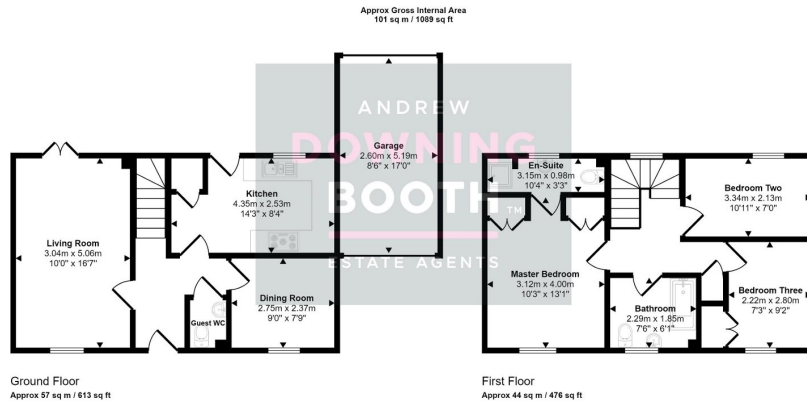

This floorplan is only for illustrative purposes and is not to scale. Measurements of rooms, doors, windows, and any items are approximate and no responsibility is taken for any error, omission or mis-statement. Icons of items such as bathroom suites are representations only and may not look like the real items. Made with Mable Spreedy 360.

- Three Bedroom Detached Property
- No Upward Chain
- Highly Desirable Location Within Darwin Park
- Garage & Driveway
- Large Dual Aspect Living Room
- Master Bedroom With En-Suite & Built In Wardrobes
- Council Tax Band: D
- EPC Rating: TBC

