



ANDREW
DOWNING
BOOTH™
ESTATE AGENTS

Stowecroft, Lichfield

£525,000

5 2 2



A very spacious and wonderfully positioned five bedroom home in an always popular location. This fabulous detached property in Stowecroft of Lichfield comes to the market with a significant number of boxes ticked, from the exceptional choice of living space, to the private, spacious garden and proximity to Stowe Pool and Lichfield City Centre. The accommodation itself is set across two floors, with an entrance hall, large lounge/diner, sitting room, kitchen, shower room and one of the bedrooms to the ground floor, whilst the four other bedrooms, bathroom and attic room occupy the first. Externally, a lawned garden and spacious driveway occupy the frontage, whilst a substantial, private and well maintained garden also laid mainly to lawn sits to the rear, with neighbouring allotments beyond. Location-wise, the property benefits from being comfortably less than a mile from the very centre of Lichfield, with all amenities available including Lichfield Cathedral, Lichfield City & Trent Valley train stations, Beacon Park, bars, restaurants and major supermarkets whilst the scenic Stowe Pool is also just a couple of minutes' walk away. A viewing is heavily advised in order to appreciate all on offer.



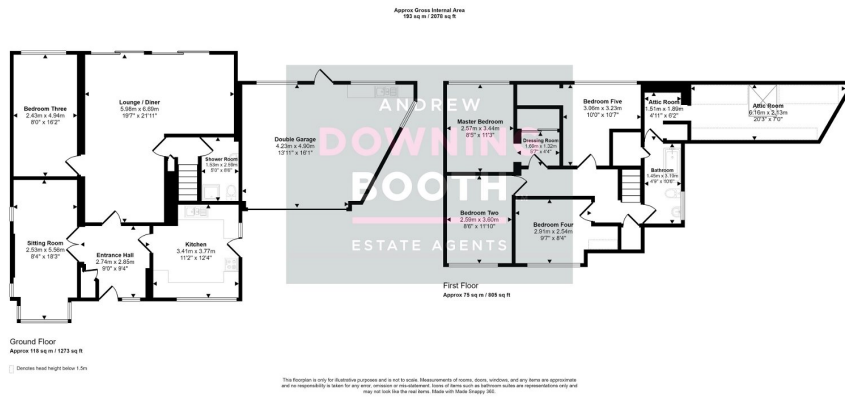

- Five Bedroom Detached Property
- Exceptional Living Space
- Generous Rear Garden Backing On To Neighbouring Allotments
- Popular Location Close To Stowe Pool & Centre Of Lichfield
- Downstairs Shower Room
- Spacious Driveway & Double Garage
- EPC Rating:
- Council Tax Band:

