



The Green, Barton-Under-Needwood
£500,000

🛏️ 2 🪑 2 🚗 2



A very rare opportunity to acquire a truly impressive and spacious detached bungalow, in a highly sought after location.

The Green of Barton-under-Needwood comes to the market with an extensive range of features bound to make you fall in love, from the impeccable presentation throughout each and every room, to the equally as impressive room sizes and all round stunning plot. Sitting in the ever in demand village of Barton-under-Needwood, it's safe to say the 'location' box is firmly ticked, with scenic walks, greenery and convenient amenities all around, with the accommodation itself comprising a fabulous through entrance hall, large living/dining room, attractive kitchen, an almost full width conservatory, two double bedrooms (Master with en-suite) and the main bathroom, whilst spectacular gardens sit to both the front and rear, with the rear even benefitting from being South-East facing.

A property of this calibre cannot be served justice using just words and pictures; a viewing is absolutely essential.



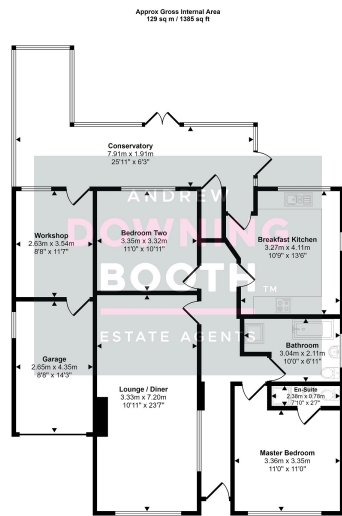

Floorplan

This floorplan is only for illustrative purposes and is not to scale. Measurements of rooms, doors, windows, and any items are approximate and no responsibility is taken for any error, omission or misstatement. Sizes of items such as bathroom suites are representations only and may not look like the real items. Made with Made Groupy 900.

- Two Double Bedroom Detached Bungalow
- Highly Desirable Location
- Immaculately Maintained, Stunning South-East Facing Garden
- EPC Rating: C
- Exquisite Presentation Throughout
- Exceptional Living Space & Conservatory
- Master Bedroom With En-Suite
- Council Tax Band: D



Score	Energy rating	Current	Potential
92+	A		
81-91	B		87 B
69-80	C	73 C	
55-68	D		
39-54	E		
21-38	F		
1-20	G		