



ANDREW
DOWNING
BOOTHTM
ESTATE AGENTS

Freer Drive, Burntwood

£440,000

3 2 2



A fabulous opportunity to acquire a beautifully presented three bedroom home in a very popular location. This impressive detached property in Freer Drive occupies a quiet position within the desirable St Matthews estate and boasts plenty of attractive features, from the stunning high specification open-plan breakfast kitchen/diner, to the equally spectacular and dual aspect Master bedroom, coming with built in bedroom furnishings and its own contemporary en-suite. Location-wise, the property benefits from having a wide range of amenities nearby, including highly rated schools, transport links, scenic surrounding countryside and a very easy commute to Lichfield and other surrounding areas. The accommodation is set across two floors, with an entrance hall, attractive living room, open-plan kitchen/diner, utility room, home office and guest WC all to the ground floor, whilst the three bedrooms (Master with en-suite) and main bathroom occupy the first floor. A charming frontage and driveway is coupled with an attractive yet low maintenance and private rear garden to make up the property's exterior. Properties offering this level of living space, bedroom space and high specification finishes throughout can only be truly appreciated when viewed in person; we must advise booking in a viewing at your earliest convenience.



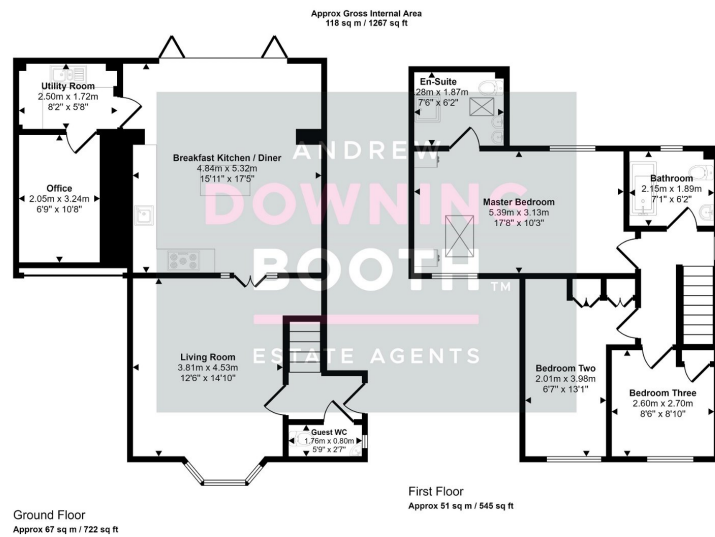

This floorplan is only for illustrative purposes and is not to scale. Measurements of rooms, doors, windows, and any items are approximate and no responsibility is taken for any error, omission or mis-statement. Icons of items such as bathroom suites are representations only and may not look like the real items. Made with Made Snappy 360.

- Three Bedroom Detached Property
- Desirable & Popular Location Close To Lichfield
- Stunning Master Bedroom With En-Suite
- Large Open-Plan Kitchen / Diner
- Utility Room & Home Office
- Attractive & Private Garden
- EPC Rating: B
- Council Tax Band: D

