



BRIAN MORAN POWERED BY **exp**™ **UK**

@ [brian.moran@exp.uk.com](mailto:brian.moran@exp.uk.com)

🌐 [brian.moran.exp.uk.com](http://brian.moran.exp.uk.com)

☎ 07939 055 524

New Road, Clifton, Shefford, SG17 5SJ

£200,000

🛏️ 2 🚿 1 🚗 1



Two bedroom park home in Clifton Park. Benefits include garage (which is rented off the site ) off road parking and all set on a generous plot. The unit has good quality fitted bedroom furniture and apart from carpet cleaning/ new carpets is ready to move into straight away. Quote BM0221 to view.



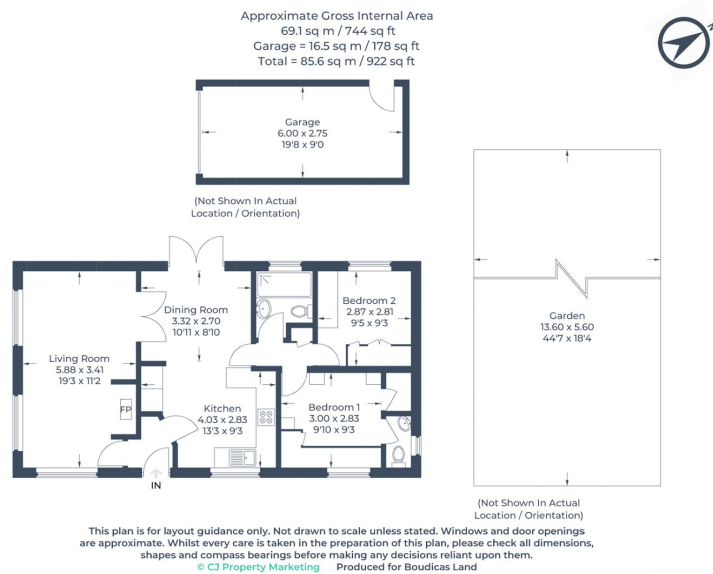

- 20 ft lounge
- Kitchen / diner
- Off road parking
- Competitively priced
- Two double bedrooms
- Garage (rented off the site)
- Good size plot
- Quote BM0221 to view

