



RAPHAEL AGBANDJE POWERED BY **exp** <sup>TM</sup> UK

@ raphael.agbandje@exp.uk.com

🌐 raphaelagbandje.exp.uk.com

☎ 0203 488 5876

## West Carriage House, Royal Carriage Mews, London SE18 6GA

£580,000

🛏️ 3 🚿 2 🚗 1

- Chain Free
- Two Luxurious Bathrooms
- Fully Integrated Kitchen
- Allocated Parking
- Close to local amenities
- Three Bedrooms
- Open Plan Reception Kitchen
- Light and Contemporary throughout
- Gym and Concierge Services
- Vast variety of transport links closeby



Presented to the market chain free complementing modern riverside living is this stylish three bedroom apartment situated in the Royal Arsenal Riverside development. Organised over an approximate 730 sq ft, the apartment is situated on the third floor and boasts floor to ceiling windows, modern kitchen with built in appliances and two luxurious stylish bathrooms. The apartment further benefits from ample storage and wrap around balcony and its own allocated parking space.

Residents of the Royal Arsenal can enjoy access to the Royal Arsenal Gym at an additional cost and a host of local amenities on site which include the Dial Arch Pub, the Guard House the Boulangerie Jade patisserie and bakery, and Tesco. Commuting in London is very convenient with easy access to the Elizabeth Line (3 minute walk), Overground and the DLR.



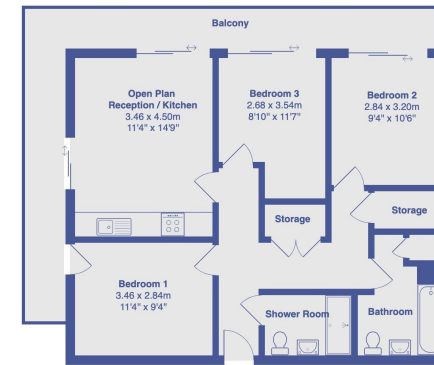

West Carriage House, Royal Carriage Mews, Woolwich, SE18 6GA

Total Area: 69.8 m<sup>2</sup> ... 751 ft<sup>2</sup> (excluding balcony)

All measurements are approximate and for display purposes only



eXp World UK Ltd is a registered company at Level 37, 25 Canada Square, London, E14 5LQ.

Registered company number is 12016573. VAT Registration Number is 327 4120 29