



RAPHAEL AGBANDJE POWERED BY **exp** TM UK

@ raphael.agbandje@exp.uk.com

🌐 raphaelagbandje.exp.uk.com

☎ 0203 488 5876

## Bignell Road, Woolwich, London SE18 6SB

Guide Price £450,000

🛏️ 3 🚿 1 🚗 1

- Three Double Bedrooms
- Organised over three floors
- Light and Neutral throughout
- Modern Kitchen/Diner
- Low Maintenance Rear Garden
- Potential to Extend STPP
- Close to Woolwich Town Centre
- Close to Local Amenities and transport



Presented to market in good condition is this smart three bedroom mid terraced, Victorian family home situated in a quiet location, under a mile to the centre of Woolwich.

The property has undergone a program of refurbishment resulting a light and neutral accommodation organised over three floors. The lower ground floor sets the stage for entertaining and family gatherings with a spacious Kitchen/ diner. The hall floor boasts cozy reception room with large window bathing this room with natural light, double bedroom with view out onto the garden and modern bathroom.





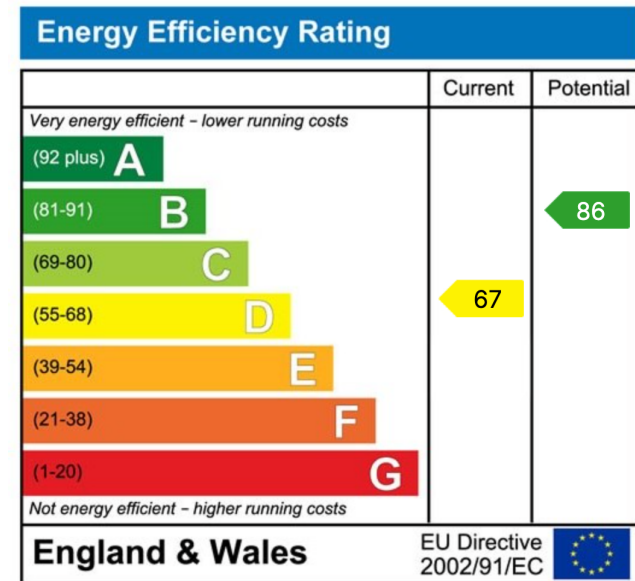
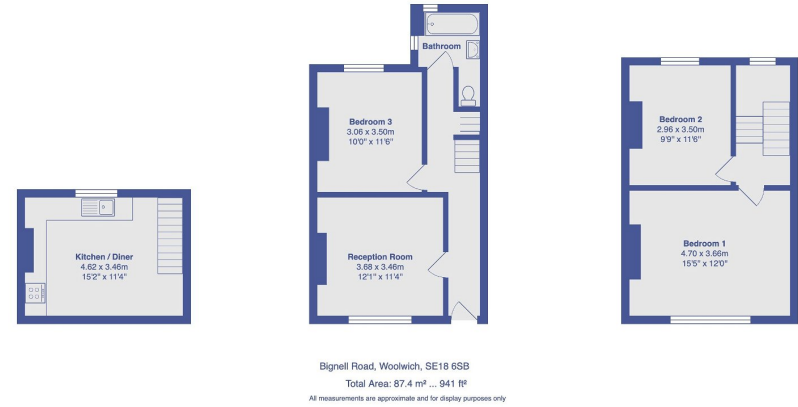

eXp World UK Ltd is a registered company at Level 37, 25 Canada Square, London, E14 5LQ.  
 Registered company number is 12016573. VAT Registration Number is 327 4120 29