

debbie fortune

ESTATE AGENTS

Hill Road, Clevedon

Guide Price £299,999

🛏 2 🚗 1 🚲 0



SEA VIEWS A spacious apartment in a converted Edwardian building located on the ever popular Hill Road with it stylish array of shops, bars, cafes and restaurants and is within close proximity of the sea front and Clevedon's Grade I listed pier.



Key Features

- Edwardian apartment in a very popular location
- Stylish interior
- Far reaching views
- EPC D
- Open plan living accommodation
- Off street parking
- Shops, bars, cafes and restaurants on the doorstep
- Council Tax band C

GROUND FLOOR
781 sq.ft. (72.5 sq.m.) approx.

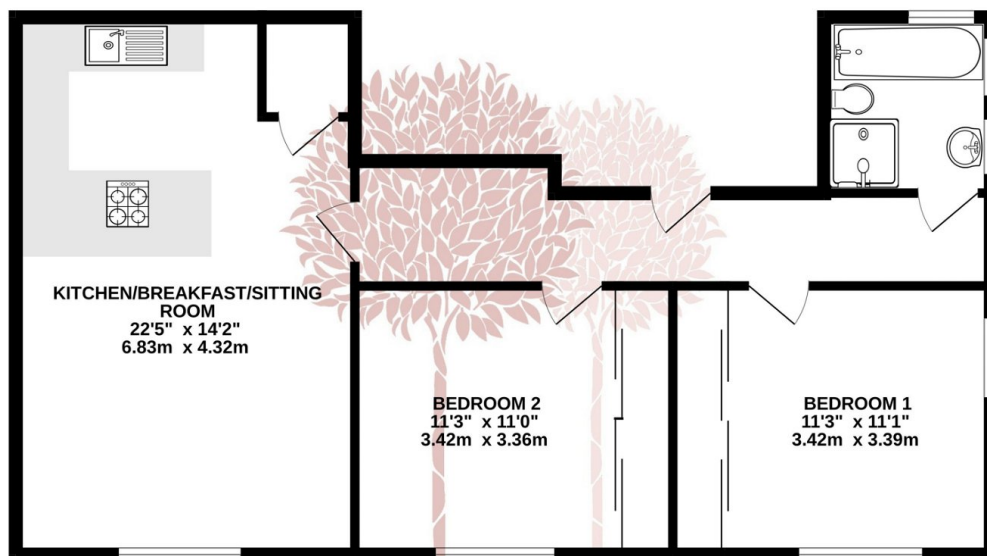

TOTAL FLOOR AREA : 781 sq.ft. (72.5 sq.m.) approx.

Whilst every attempt has been made to ensure the accuracy of the floorplan contained here, measurements of doors, windows, rooms and any other items are approximate and no responsibility is taken for any error, omission or mis-statement. This plan is for illustrative purposes only and should be used as such by any prospective purchaser. The services, systems and appliances shown have not been tested and no guarantee as to their operability or efficiency can be given.

Made with Metropix ©2024

