



debbie fortune

ESTATE AGENTS

St. Congars Way, Congresbury

£535,000

 4  3  3



An exceptionally spacious four bedroom detached family home set in a popular modern development in the heart of Congresbury. Brought to the market with the benefit of a large single garage, off street parking and west facing rear garden.



Key Features

- Detached modern four bedroomed family home
- Perfect family home
- Open plan kitchen/dining area
- West facing rear garden
- EPC B
- Wonderfully proportioned rooms
- Large single garage with two allocated parking spaces
- Close to local amenities
- No onward chain
- Council Tax Band F

GROUND FLOOR
875 sq.ft. (81.3 sq.m.) approx.

1ST FLOOR
861 sq.ft. (80.0 sq.m.) approx.

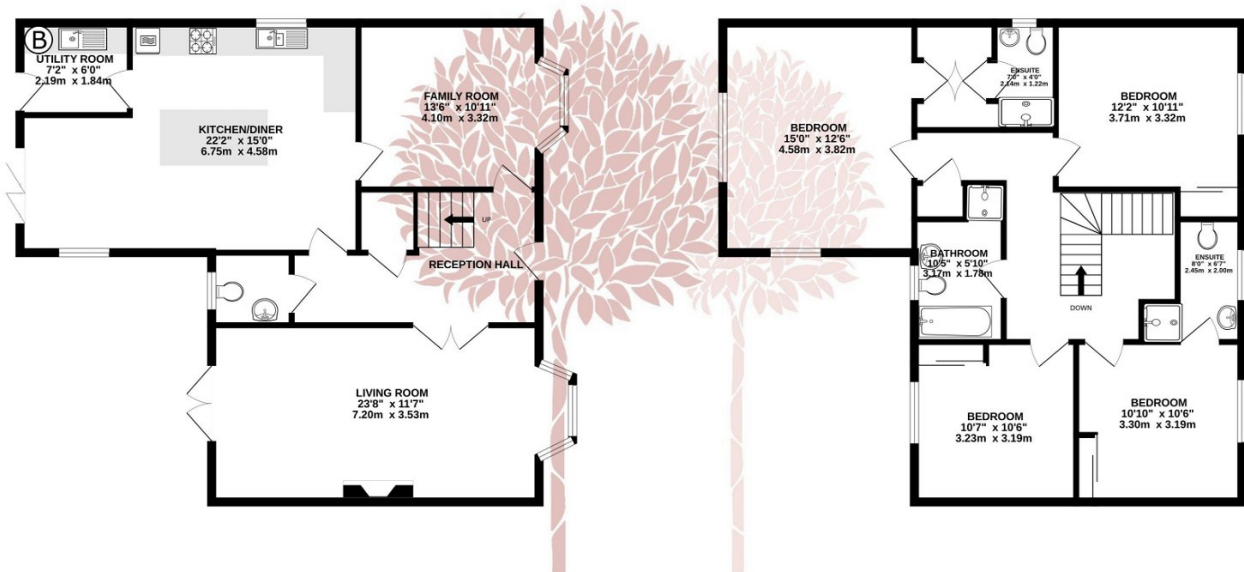

TOTAL FLOOR AREA: 1736 sq.ft. (161.3 sq.m.) approx.

Whilst every attempt has been made to ensure the accuracy of the floorplan contained here, measurements of doors, windows, rooms and any other items are approximate and no responsibility is taken for any error, omission or mis-statement. This plan is for illustrative purposes only and should be used as such by any prospective purchaser. The services, systems and appliances shown have not been tested and no guarantee as to their operability or efficiency can be given.

Made with Metropix ©2024

