

debbie fortune

ESTATE AGENTS

Venus Street, Congresbury

£430,000

5 1 2



WONDERFUL FAMILY HOME- Five bedroomed semi-detached property set in a lovely quiet position close to both local amenities and also miles of beautiful footpaths and bridleways.



Key Features

- Extended five bedroom semi-detached home
- Integral garage and ample off street parking
- Gas central heating and double glazing
- Good sized kitchen/dining room with french doors to the garden
- Churchill School and 6th Form catchment
- Convenient edge of village position
- Lawned gardens to both front and rear and large workshop
- Sitting room with feature fireplace and southerly aspect
- Utility room and ground floor cloakroom
- EPC TBC

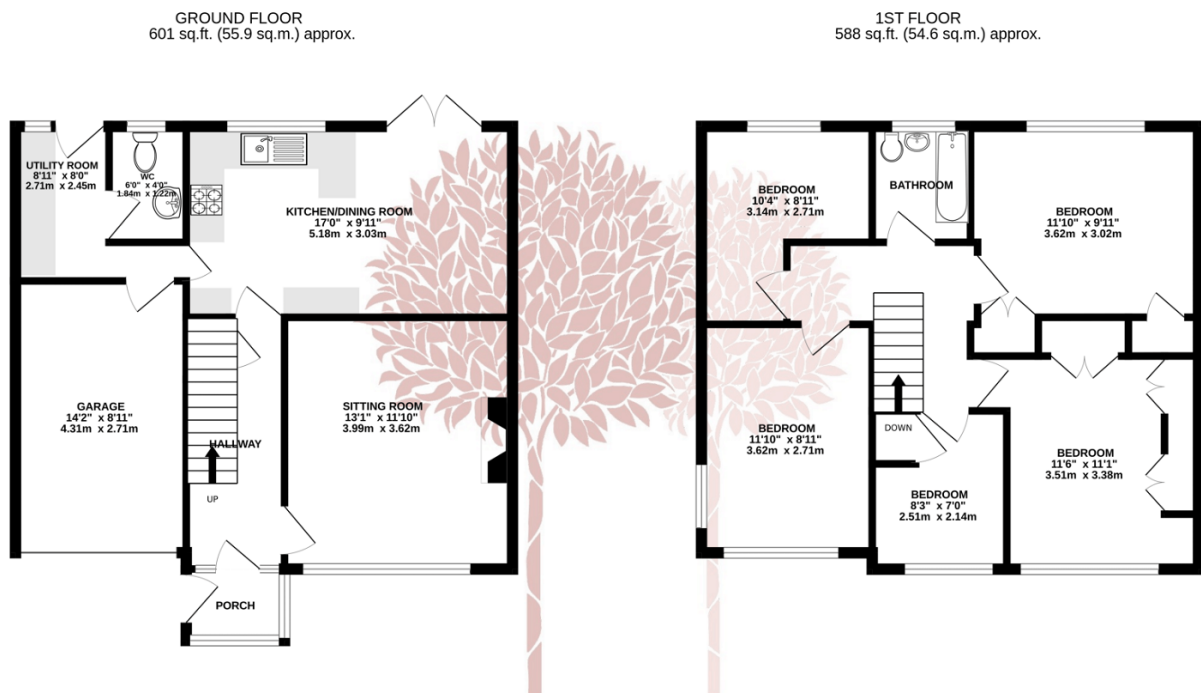

TOTAL FLOOR AREA : 1189 sq.ft. (110.5 sq.m.) approx.

Whilst every attempt has been made to ensure the accuracy of the floorplan contained here, measurements of doors, windows, rooms and any other items are approximate and no responsibility is taken for any error, omission or mis-statement. This plan is for illustrative purposes only and should be used as such by any prospective purchaser. The services, systems and appliances shown have not been tested and no guarantee as to their operability or efficiency can be given.
Made with Metropix ©2024

