

## Fosseway, Clevedon

£267,500

🛏 2 🚿 1 🚗 1



**FIRST TIME BUYERS-** This light and airy, two bedroom, end terraced home is brought to the market with the huge advantage of vacant possession and comes with ample off street parking, gardens to both the front and rear and a single garage. A perfect first time buy, downsize, or perhaps investment opportunity.



## Key Features

- Ideal first time purchase or buy to let opportunity
- Newly decorated and carpeted throughout
- Lawned gardens to both the front and rear
- Two bedroom end of terrace home
- Council Tax Band B
- Offered to the market with no onward chain complications
- Convenient position for local amenities and the sea front
- Generous off street parking plus single garage
- EPC D

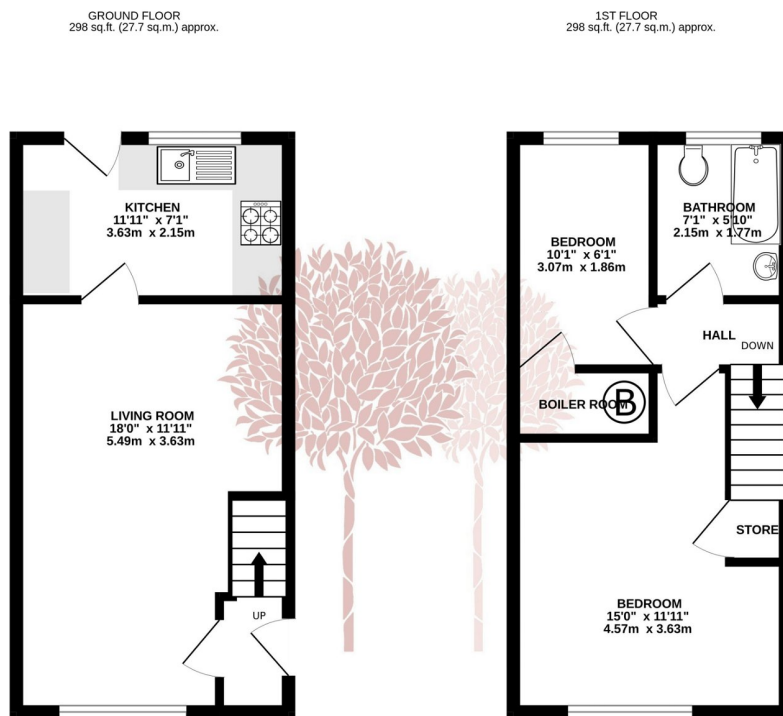

TOTAL FLOOR AREA - 597 sq.ft. (55.4 sq.m.) approx.

Whilst every attempt has been made to ensure the accuracy of the floorplan contained here, measurements of doors, windows, rooms and any other items are approximate and no responsibility is taken for any error, omission or mis-statement. This plan is for illustrative purposes only and should be used as such by any prospective purchaser. The services, systems and appliances shown have not been tested and no guarantee as to their operability or efficiency can be given.  
Made with Metropix ©2024

