

debbie fortune

ESTATE AGENTS

Somerville Road, Winscombe

£415,000

3 1 2



A DETACHED three-bedroom family home in a peaceful village location backing onto woodland. The property benefits from off street parking and garage.



Key Features

- Detached home in a village location
- Large sitting/dining room, conservatory
- Off street parking and single garage
- Council Tax band D
- Three bedrooms
- Countryside walks on the doorstep
- Private garden backing onto woodland
- EPC rating D

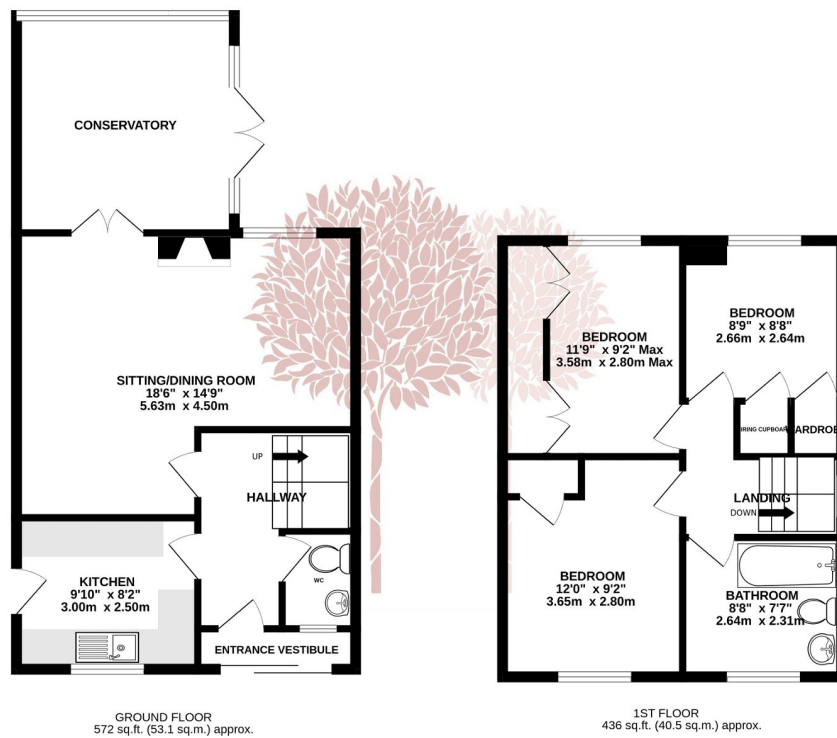

TOTAL FLOOR AREA: 1007 sq.ft. (93.6 sq.m.) approx.

Whilst every attempt has been made to ensure the accuracy of the floorplan contained here, measurements of doors, windows, rooms and any other items are approximate and no responsibility is taken for any error, omission or mis-statement. This plan is for illustrative purposes only and should be used as such by any prospective purchaser. The services, systems and appliances shown have not been tested and no guarantee as to their operability or efficiency can be given.

Made with Metroplan ©2023

