

## Main Road, Temple Cloud

£270,000

🛏 2 🚿 1 🚗 1



**BURSTING WITH POTENTIAL** – This quintessential two-bedroom cottage in Temple Cloud with a private garden and outbuildings.



## Key Features

- Two bedroom cottage with enclosed garden
- Outbuildings and greenhouse
- Central to local amenities
- In need of modernisation
- EPC rating F
- Original feature fireplaces
- Mature garden
- Easy commute to Bristol and Bath
- NO CHAIN
- Council Tax band C

GROUND FLOOR  
453 sq.ft. (42.1 sq.m.) approx.



1ST FLOOR  
283 sq.ft. (26.3 sq.m.) approx.

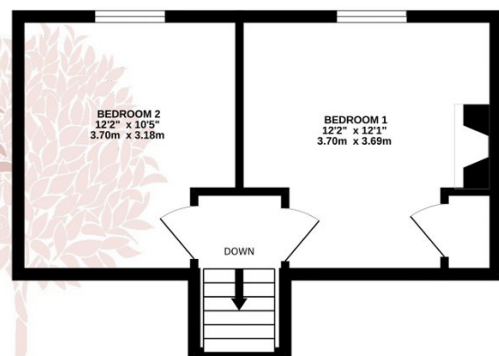

TOTAL FLOOR AREA : 736 sq.ft. (68.3 sq.m.) approx.

Whilst every attempt has been made to ensure the accuracy of the floorplan contained here, measurements of doors, windows, rooms and any other items are approximate and no responsibility is taken for any error, omission or mis-statement. This plan is for illustrative purposes only and should be used as such by any prospective purchaser. The services, systems and appliances shown have not been tested and no guarantee as to their operability or efficiency can be given.  
Made with Metropix ©2023

