

## Middle Street, East Harptree

Offers In Region Of £375,000

3 2 2



**EXTENDED FAMILY HOME** in the heart of East Harptree which offers two reception rooms, separate kitchen, utility, boot-room and three double bedrooms! There is a lovely large garden with incredible views and a further courtyard and parking to the rear along with a single garage and large carport.



## Key Features

- Three bedroom semi-detached house
- Separate utility room
- Bootroom / Cloakroom
- Downstairs bedroom with ensuite bathroom
- Large garden with far reaching views
- Separate dining room
- Central village location
- Single garage with electric door plus off Street parking and car/caravan port
- EPC rating C
- Council Tax band C

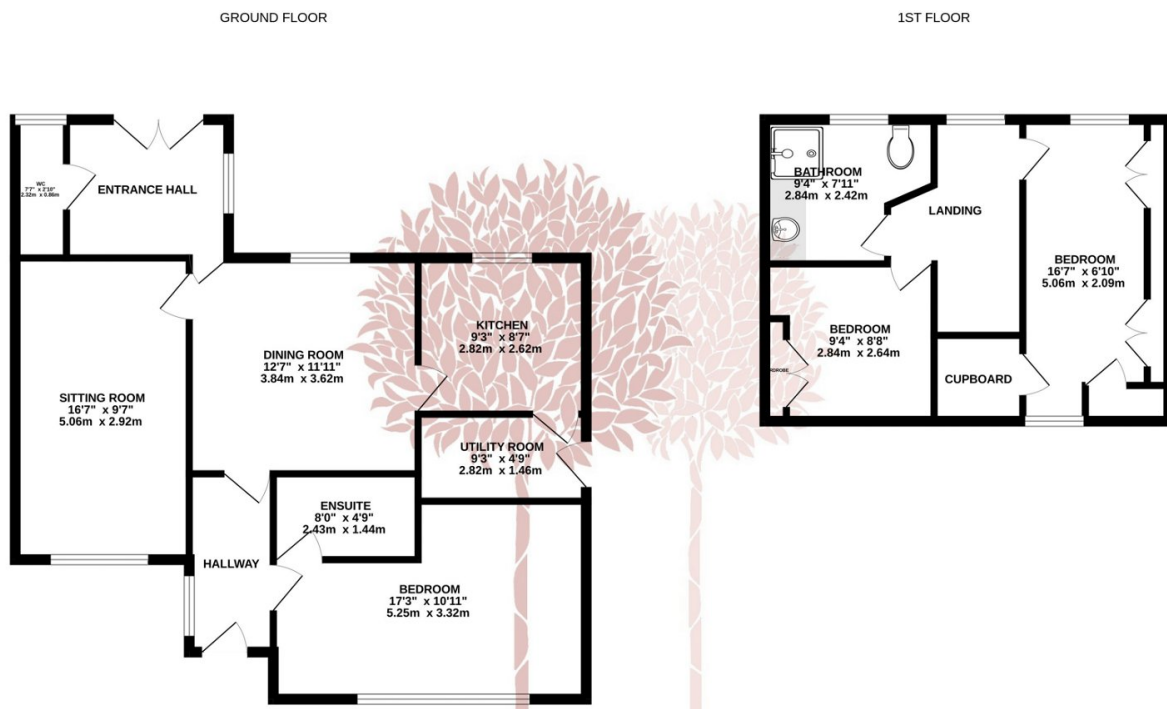

Whilst every attempt has been made to ensure the accuracy of the floorplan contained here, measurements of doors, windows, rooms and any other items are approximate and no responsibility is taken for any error, omission or mis-statement. This plan is for illustrative purposes only and should be used as such by any prospective purchaser. The services, systems and appliances shown have not been tested and no guarantee as to their operability or efficiency can be given.  
Made with Metropix ©2023

