

# debbie fortune

ESTATE AGENTS

## 8 Mayors Road Claverham,

£545,000

🛏️ 4 🍳 2 🚗 2



**SUPERB OUTLOOK** - Constructed in recent years by well-respected housebuilder Newland Homes is this fantastic, detached family home situated in a stunning parkland like setting on the edge of the popular village of Claverham.



## Key Features

- Beautifully presented four-bedroom detached contemporary home
- Constructed in recent years by Messrs' Newland Homes to an exacting standard
- Two well-appointed bathrooms plus ground floor cloakroom
- Backwell School and 6th form catchment,
- Council Tax band
- Parkland like edge of village setting
- Spacious bay fronted sitting room and exceptional Kitchen/dining/sunroom
- Single garage, generous off-road parking for 3-4 vehicles
- Photo voltaic solar panels/Electric car charging point
- EPC rating B

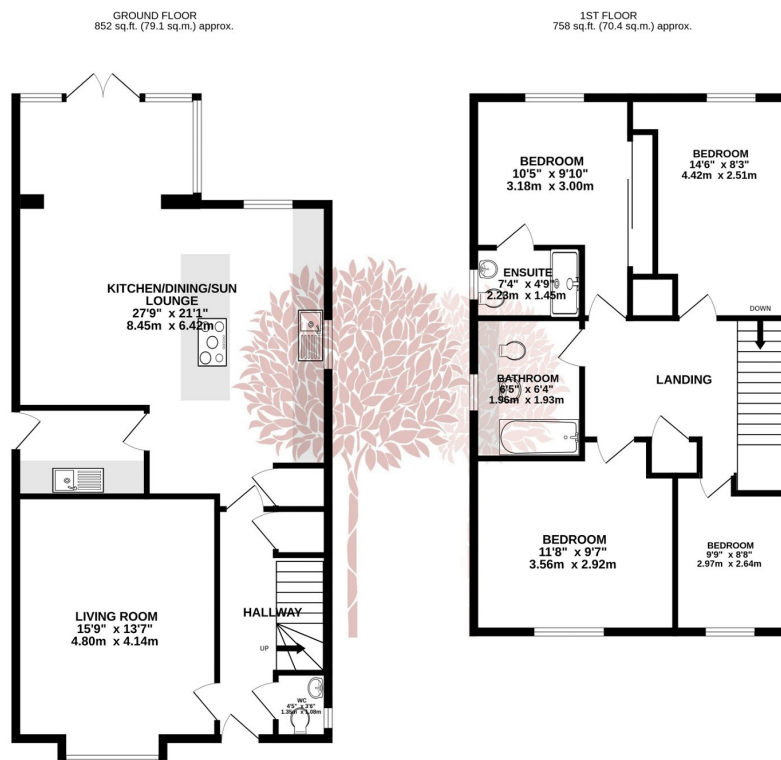

TOTAL FLOOR AREA: 1610 sq.ft. (149.6 sq.m.) approx.

Whilst every attempt has been made to ensure the accuracy of the floorplans contained here, measurements of doors, windows, rooms and any other items are approximate and no responsibility is taken for any error, omission or misstatement. This plan is for illustrative purposes only and should be used as such by any prospective purchaser. The services, systems and appliances shown have not been tested and no guarantee as to their operability or efficiency can be given.

Made with Metropix (2023)

