

debbie fortune

ESTATE AGENTS

Nore Road, Portishead

£1,475,000

🛏 5 🚿 3 🚗 5



A truly magnificent period home occupying an outstanding elevated position with glorious uninterrupted estuary views, extensive lateral accommodation of approximately 3275 sq ft, and an exceptional landscaped garden of approaching an acre.



Key Features

- EPC E
- Council Tax Band G
- One of Portishead's Finest family homes
- Plethora of original and restored features
- Four generous receptions rooms, plus summer room and Conservatory
- Generous off-street parking plus large garage
- Five double bedrooms, Three bathrooms
- Truly impressive 0.87 acres of grounds and landscaped gardens
- Elevated coastal position with outstanding estuary views
- Substantial (3275 sq ft) detached period residence

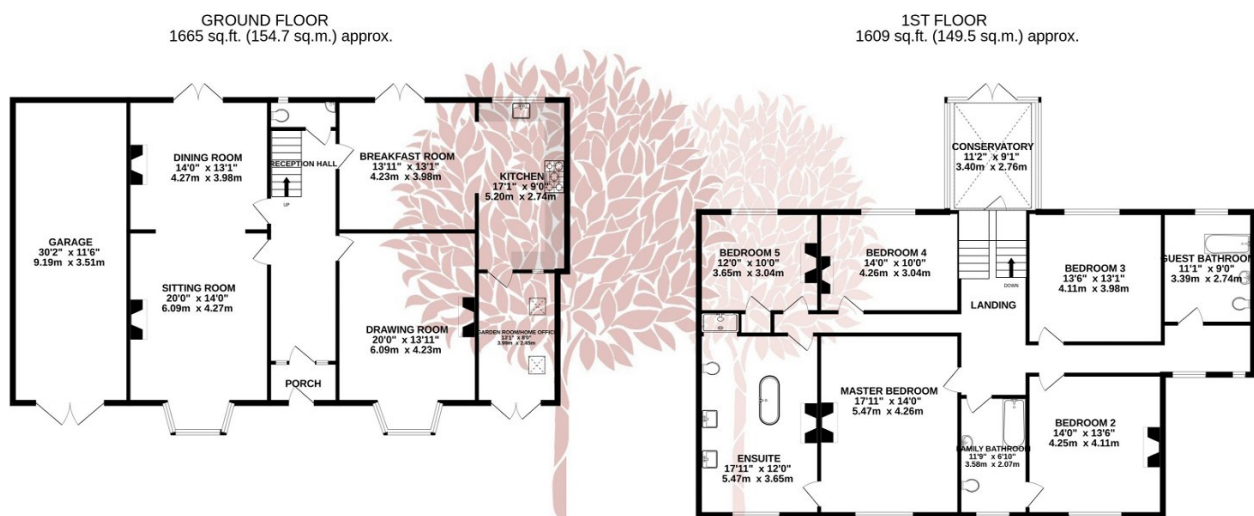

TOTAL FLOOR AREA: 3275 sq.ft. (304.2 sq.m.) approx.

Whilst every attempt has been made to ensure the accuracy of the floorplan contained here, measurements of doors, windows, rooms and any other items are approximate and no responsibility is taken for any error, omission or mis-statement. This plan is for illustrative purposes only and should be used as such by any prospective purchaser. The services, systems and appliances shown have not been tested and no guarantee as to their operability or efficiency can be given.
Made with Metropix ©2023

