



POWERED BY  
**NIKKI DAVIES** **exp**™ **UK**

@ [nikki.davies@exp.uk.com](mailto:nikki.davies@exp.uk.com)

[nikkidavies.exp.uk.com](http://nikkidavies.exp.uk.com)

☎ 07770 976 137

# Beacon Road, Romiley, Stockport

Guide Price £495,000

4 2 1



- \*\*\* CHECK OUT OUR VIDEO TOUR \*\*\*
- A contemporary detached family home on a popular estate in Romiley
- Close to Overdale Park and Chadkirk Country Estate
- Beautiful bathroom and ensuite plus WC to ground floor
- Parking on the drive and an integral single garage
- Quote Ref: ND0151
- Four double bedrooms, master with ensuite
- Magnificent open plan living dining area
- Generous garden with large patio area, lawn and summerhouse to rear garden
- Viewings immediately available



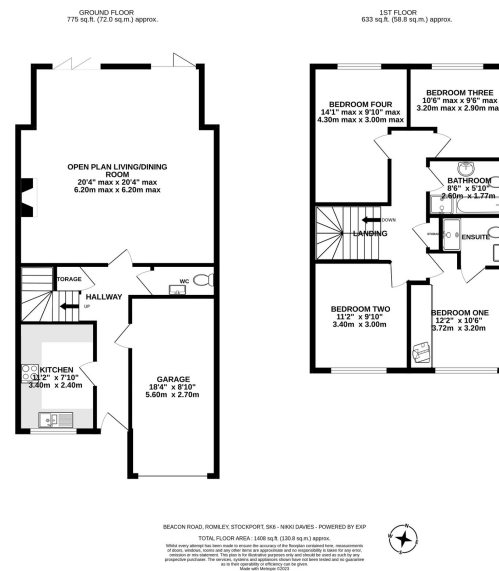

Welcome to Beacon Road. If you are seeking the perfect blend of modern luxury and style within a family friendly setting, No. 34 could be the one for you.

Presented a very high standard, this 2015 built detached home is the true definition of a turnkey property.

**VIDEO TOUR AVAILABLE TO VIEW**

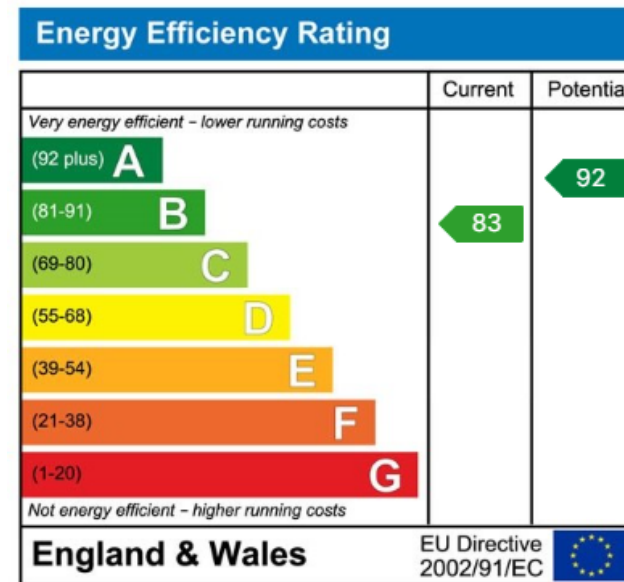

eXp World UK Ltd is a registered company at Level 37, 25 Canada Square, London, E14 5LQ.

Registered company number is 12016573. VAT Registration Number is 327 4120 29