



POWERED BY
NIKKI DAVIES **exp**™ **UK**

@ nikki.davies@exp.uk.com

nikkidavies.exp.uk.com

☎ 07770 976 137

Middlewood Walk, Marple, Stockport, SK6 7NF

£335,000

🛏 3 🚿 2 🚗 2

- A beautifully presented and immaculate three storey townhouse
- Open plan kitchen dining space with French doors to garden
- Tasteful neutral décor throughout
- Well maintained enclosed rear garden
- Property Ref: ND0151 – Middlewood Walk
- On the doorstep of the Middlewood Way
- Master bedroom to second floor with built in wardrobes and ensuite
- WC to ground floor
- Allocated parking space and visitor parking
- EPC: C



Welcome to your new dream home. This beautifully presented modern three-storey town house looks over the Middlewood Way and is situated at the edge of a popular development in the Rose Hill area of Marple. For anyone seeking a ready to move into home located within walking distance to the bustling centre of Marple, great schools and all your local amenities, Middlewood Walk is ideal.

Originally known as The Coppice by Morris Homes, the property was built just a decade ago in 2013. The layout has been carefully considered with the ground floor devoted to living accommodation; two bedrooms and the family bathroom to the first floor and the entire top floor forms the master suite. Middlewood Walk is an attractive row of five townhouses looking out on to the Middlewood Way and number 7 sits at one end of the row. From the moment you arrive, the tone is set for style and elegance with a well-tended, landscaped frontage and a welcoming entrance.

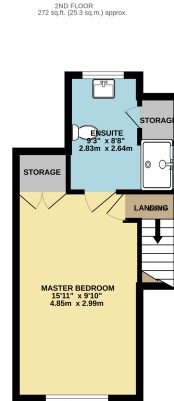
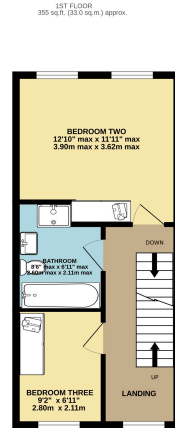
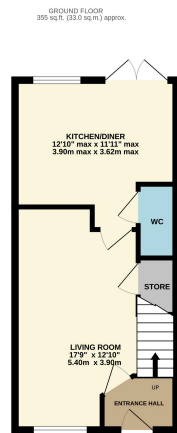

PRESENTED BY NIKO DAVIES, POWERED BY eXp
TOTAL FLOOR AREA: 983 sq.ft. (91.3 sq.m.) approx.
While every attempt has been made to ensure the accuracy of the floorplan contained herein, measurements of doors, windows, rooms and any other items are approximate and no responsibility is taken for any error, omission or mis-statement. This plan is for illustrative purposes only and should be used as such by any prospective purchaser. The services, systems and appliances shown hereon may have been tested and not guaranteed as to their operability or efficiency can be given.
Made with floorplan10000



eXp World UK Ltd is a registered company at Level 37, 25 Canada Square, London, E14 5LQ.
Registered company number is 12016573. VAT Registration Number is 327 4120 29