



**HENDERSON
CONNELLAN**
ESTATE AGENTS

Queen Street, Geddington NN14

"Character Building"

5 3 3



"Character Building"

This exceptional Grade II * listed stone and thatched farmhouse is situated in the heart of Geddington, a moment's walk from the idyllic bridge and ford as well as the historic Queen Eleanor Cross, yet a short drive to Kettering or Corby mainline railways with direct trains under an hour to St Pancras International. The exterior conceals a substantial interior brimming with character with an entrance hall with limestone flooring which extends through to the kitchen/breakfast room with Range cooker and oak worksurfaces. The dining room is an atmospheric room with flagstone flooring and exposed beams, the versatile family room/snug has an inglenook fireplace and the warmth of a wood burner as well as engineered oak board flooring which can also be found in the light-filled living room enjoying a working open fire and the impressive Georgian built in corner cupboard which is * listed. Upstairs the sizeable landing leads to a principal bathroom, separate shower room and five double bedrooms, the master bedroom with dressing room and en-suite bathroom with roll top bath. The lovely grounds feature a foregarden set behind a Victorian wrought iron railings, the private rear garden is discreetly set behind stone and brick walling with fruit trees and patio areas allowing you to follow the sun, and a driveway with parking for three cars leads to an oversized garage. The village has variety of clubs and societies, a pub, church and a respected primary school as well as being in reach of a number of independent schools. An exceptional character home in a most desirable village.



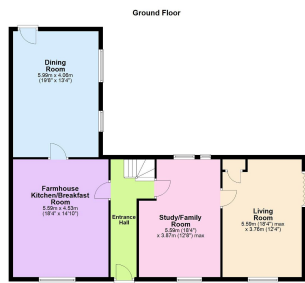

- Village Location
- Thatched
- Five Bedrooms
- Parking for Three Cars
- EPC - Exempt
- Grade II
- Close to Schools
- Inglenook Fire Palce
- Mature Gardens
- Council Tax - D



15-16 Market Place, Kettering,
Northamptonshire, NN16 0AJ

Disclaimer: These particulars do not form part of any offer or contract and should not be relied upon as statements or representations of fact. Any areas, measurements of distances are approximate. The text, photographs and plans are for guidance only and are not necessarily comprehensive.

