



Avery Hill Road, New Eltham, SE9

Guide Price £275,000

🛏️ 2 🍳 1 🚗 1



- Two Bedroom Ground Floor Apartment
- Long Lease Length
- Communal Garden Space
- Ideally Located For New Eltham Village Shops, Eateries & Amenities
- EPC Rating D - Potential C
- Quiet Residential Block Of Just Four Flats
- Private Allocated Parking
- Walking Distance To New Eltham Railway Station
- Excellent Bus Links Keeping You Connected With Greenwich, Eltham & Chislehurst
- Chislehurst Band C - Royal Borough of Greenwich



*** GUIDE PRICE £275,000 -£300,000 ***

Introducing Avery Hill Road - An Ideal First Time Purchase Or Buy To Let Investment!

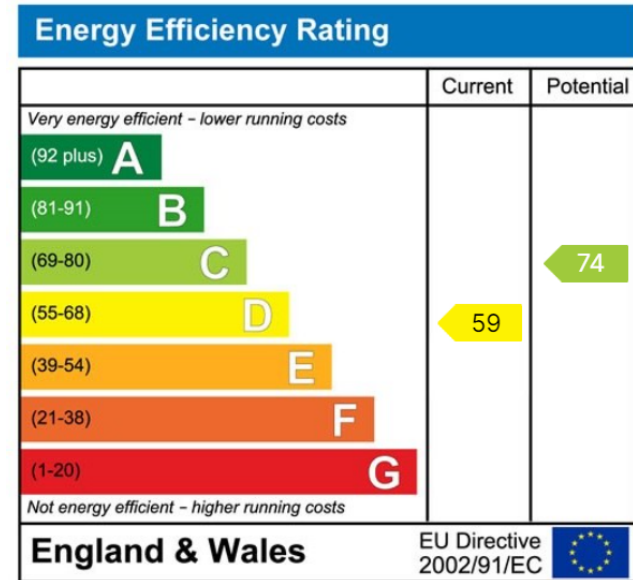
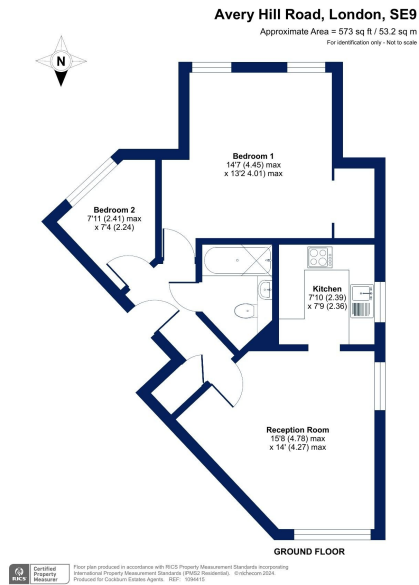

Cockburn EA

352 Footscray Road,
 London, SE9 2EB

t: 020 8859 8590