



Neckinger Estate, Bermondsey, SE16

£1,700PCM (Deposit: £1,961)

🛏️ 2 🚿 1 🚻 1



Tax Band: A Furnished: Unfurnished

GUIDE PRICE - £1700-£1800pcm

Equidistant to both London Bridge and Bermondsey Underground Train Stations, for Northern and Jubilee Line Services. Within sight of excellent local amenities which includes; Restaurants, Bars, Shops, Supermarkets, Museums, Gyms and Parkland. Comprising two spacious double bedrooms, a bright and airy reception room, separate kitchen and modern bathroom. Move in date from: beginning of April. 1x week holding deposit to be paid to secure the property. Total 5x weeks security deposit.





Neckinger Estate, London, SE16

Approximate Area = 605 sq ft / 56.2 sq m
For information only - Not to scale

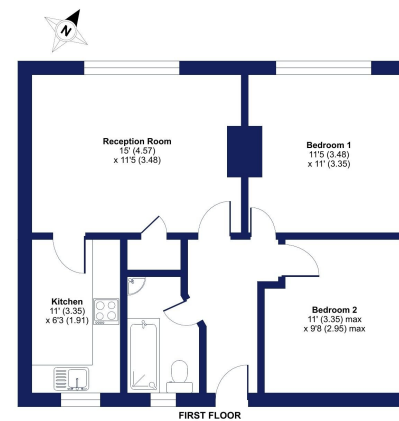

Floor plan produced in accordance with NPMA (Physical Measurement Standards) incorporating International Property Measurement Standards (IPMS) Assessment. © 2024 August 2024. Professional Councils: Estate Agents, RICS, 1000000.



Cockburn EA

352 Footscray Road,
London, SE9 2EB

t: **020 8859 8590**