



Blanmerle Road, New Eltham, SE9

Guide Price £450,000

3 1 1



- Chain Free Sale
- Three Bedroom Bungalow
- Modernisation Needed
- Large Through Reception Room
- Garden To Rear
- On-Street Permit Parking
- Walking Distance To New Eltham Railway Station & Bus Links
- Close By To New Eltham Shops, Eateries & Amenities
- EPC Rating E - Potential B
- Council Tax Band D - Royal Borough Of Greenwich



*** CHAIN FREE - GUIDE PRICE £450,000 - £475,000 ***

Welcome to Blanmerle Road - A large three-bedroom semi-detached bungalow situated in the highly sought-after area of New Eltham.

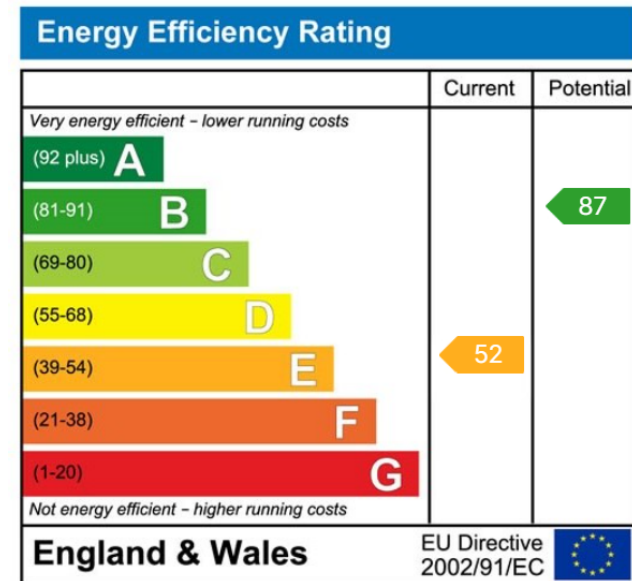
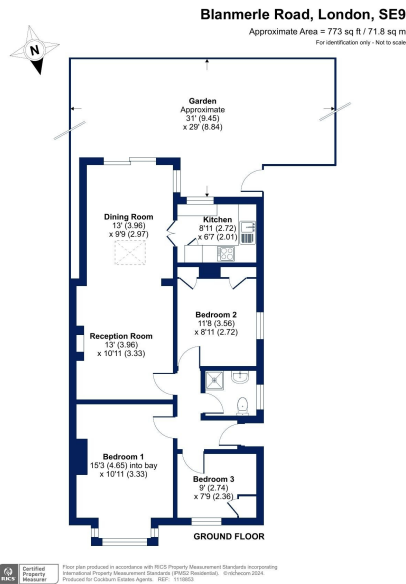

Cockburn EA

352 Footscray Road,
 London, SE9 2EB

t: 020 8859 8590